

PROCEDURES:

1. EACH ITEM MUST BE PACKAGED INDIVIDUALLY AND IDENTIFIED BY PART NUMBER AND DESCRIPTION.
2. PACK ALL ITEMS IN A SINGLE CONTAINER FOR SHIPPING.

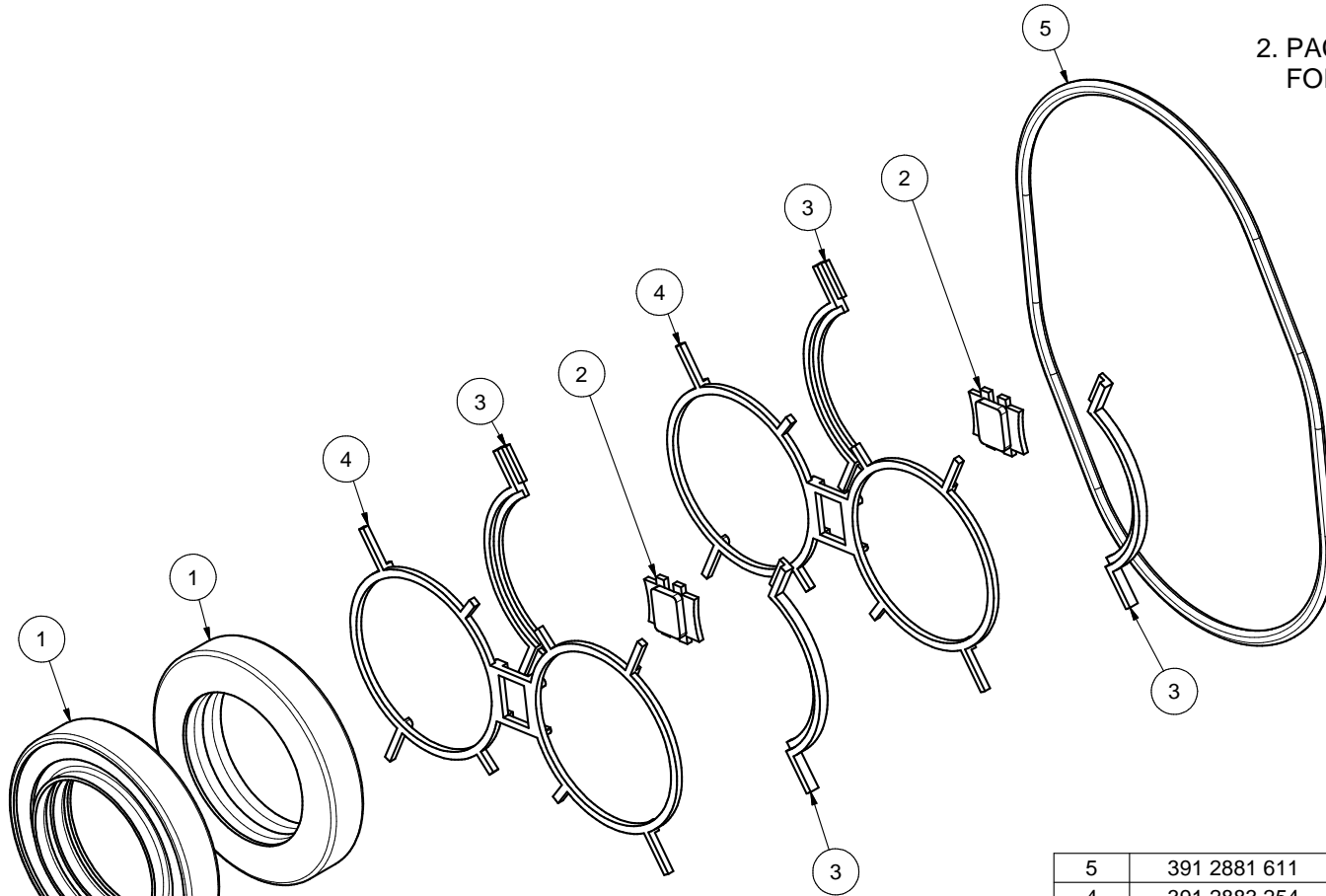

ITEM	PART NUMBER	QTY	DESCRIPTION
5	391 2881 611	1	SEAL, O-R
4	391 2883 254	2	SEAL, BK-UP
3	391 2883 252	4	ENDSEAL, CHAN
2	391 2883 253	2	CENTERSEAL, CHAN
1	391 2883 115	2	SEAL, LIP

THIS DOCUMENT CONTAINS INFORMATION THAT IS CONFIDENTIAL AND PROPRIETARY TO PARKER-HANNIFIN CORPORATION ("PARKER"). THIS DOCUMENT IS FURNISHED ON THE UNDERSTANDING THAT THE DOCUMENT AND THE INFORMATION IT CONTAINS WILL NOT BE COPIED OR DISCLOSED TO OTHERS OR USED FOR ANY PURPOSE OTHER THAN CONDUCTING BUSINESS WITH PARKER, AND WILL BE RETURNED AND ALL FURTHER USE DISCONTINUED UPON REQUEST BY PARKER. ALL RIGHTS RESERVED.

Parker Hydraulic
 Parker-Hannifin Corp.
 Gear Pump Division
 Youngstown, OH 44501
 USA

KIT,SERV=PGM640(1GR)SEAL-SFT+GSKT+CHAN+CENTER

MATERIAL	ADM CTR	P
H.E.-STD:	REV DTE	000000
	WT.	.25

DR. BY	DATE	CH. BY	DATE	SCALE
RH	111005	RAG	111005	1:1
391 1801 451				
© 2005 Parker-Hannifin Corporation				

EXP NO.
FIRST USED
PM-17962
391 1801 451

SYM.	REVISIONS
------	-----------