

	Flange MF1/MF2 ¹	Foot brackets MS1 ²	Pivot bracket with rigid bearing AB7 ³	Swivel eye bracket MP6 ⁴	Clevis bracket MP2 ⁵
Ø 32	P1C-4KMB	P1C-4KMF	P1C-4KMDB	PD23843	P1C-4KMTB
Ø 40	P1C-4LMB	P1C-4LMF	P1C-4LMDB	PD23844	P1C-4LMTB
Ø 50	P1C-4MMB	P1C-4MMF	P1C-4MMDB	PD23845	P1C-4MMTB
Ø 63	P1C-4NMB	P1C-4NMF	P1C-4NMDB	PD23846	P1C-4NMTB
Ø 80	P1C-4PMB	P1C-4PMF	P1C-4PMDB	PD23847	P1C-4PMTB
Ø 100	P1C-4QMB	P1C-4QMF	P1C-4QMDB	PD23848	P1C-4QMTB
Ø 125	P1C-4RMB	P1C-4RMF	P1C-4RMDB	PD23849	P1C-4RMTB
	Clevis bracket MP4 ⁶	Clevis bracket AB6 ⁷	Pivot bracket with swivel bearing CS7 ⁸	3 and 4 positions flange JP1	Pivot brackets AT4 ¹⁰ for MT* trunnion
Ø 32	PD23412	P1C-4KMCB	KC5130	P1E-6KB0	PD23381
Ø 40	PD23413	P1C-4LMCB	KC5131	P1E-6LB0	PD23382
Ø 50	PD23414	P1C-4MMCB	KC5132	P1E-6MB0	PD23382
Ø 63	PD23415	P1C-4NMCB	KC5133	P1E-6NB0	PD23383
Ø 80	PD23416	P1C-4PMCB	KC5134	P1E-6PB0	PD23383
Ø 100	PD23417	P1C-4QMCB	KC5135	P1E-6QB0	PD23384
Ø 125	PD23418	P1C-4RMCB	KC5136		PD23384
	Flange trunnion MT5/MT6 ¹¹	Swivel rod eye AP6 ¹²	Clevis AP2 ¹³	Flexo coupling PM5 ¹⁴	Zinc-plated nut MR9 ¹⁵ (pack of 10)
Ø 32	P1D-4KMYF	P1C-4KRS	P1C-4KRC	P1C-4KRF	P14-4KRPZ
Ø 40	P1D-4LMYF	P1C-4LRS	P1C-4LRC	P1C-4LRF	P14-4LRPZ
Ø 50	P1D-4MMYF	P1C-4MRS	P1C-4MRC	P1C-4MRF	P14-4MRPZ
Ø 63	P1D-4NMYF	P1C-4MRS	P1C-4MRC	P1C-4MRF	P14-4MRPZ
Ø 80	P1D-4PMYF	P1C-4PRS	P1C-4PRC	P1C-4PRF	P14-4PRPZ
Ø 100	P1D-4QMYF	P1C-4PRS	P1C-4PRC	P1C-4PRF	P14-4PRPZ
Ø 125		P1C-4RRS	P1C-4RRC	P1C-4RRF	P14-4RRPZ

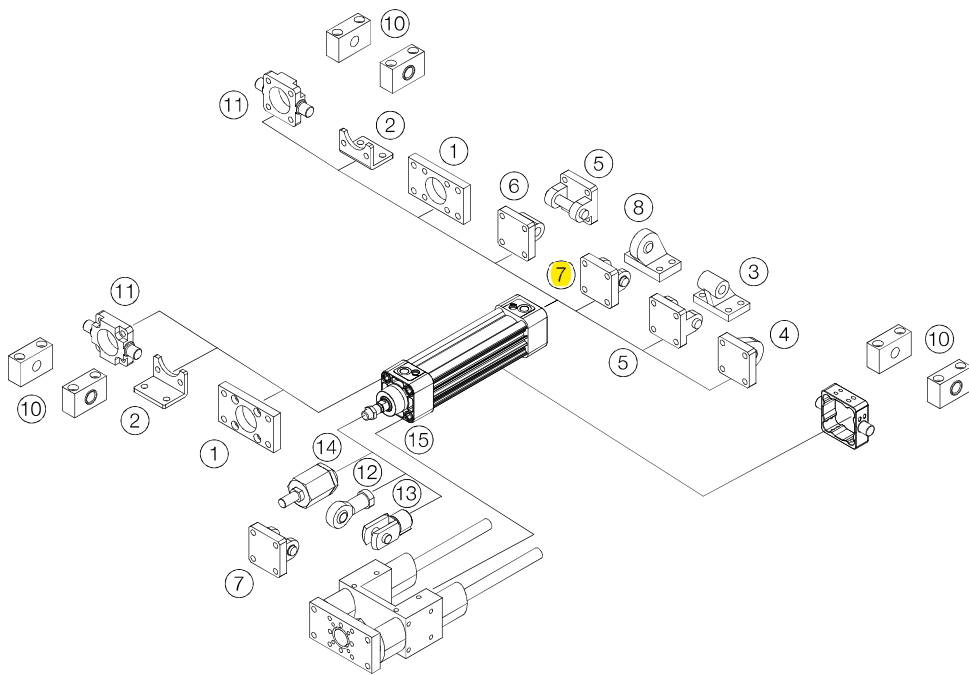

Clevis bracket MP4 ⑥



Intended for flexible mounting of cylinder. Clevis bracket MP4 can be combined with clevis bracket MP2.

Material:
Clevis bracket: Aluminium
Mounting screws acc. to DIN 912: Zinc-plated steel 8.8

Supplied complete with mounting screws for attachment to cylinder.

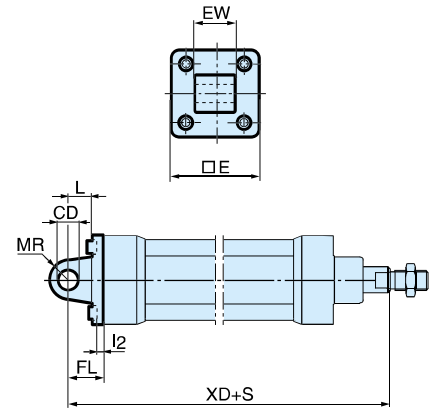

Cyl. bore mm	E mm	EW mm	FL mm	L mm	l2 mm	CD mm	MR mm	XD mm	Weight (kg)	Order code
32	47	26	22	13	±0,2	6,0	10	142	0,09	PD23412
40	55	28	25	16	±0,2	6,0	12	160	0,13	PD23413
50	65	32	27	16	±0,2	7,0	12	170	0,17	PD23414
63	78	40	32	21	±0,2	7,0	16	190	0,36	PD23415
80	95	50	36	22	±0,2	10,0	16	210	0,46	PD23416
100	115	60	41	27	±0,2	10,5	20	230	0,83	PD23417
125	140	70	50	30	±0,2	10,5	25	275	1,53	PD23418

S = Stroke length

Clevis bracket AB6 ⑦



Intended for flexible mounting of cylinder. Clevis bracket GA can be combined with pivot bracket with swivel bearing, swivel eye bracket and swivel rod eye.

Material:
Clevis bracket: Surface-treated aluminium
Pin: Surface hardened steel
Locking pin: Spring steel
Circlips according to DIN 471: Spring steel
Mounting screws acc. to DIN 912: Zinc-plated steel 8.8

Supplied complete with mounting screws for attachment to cylinder.

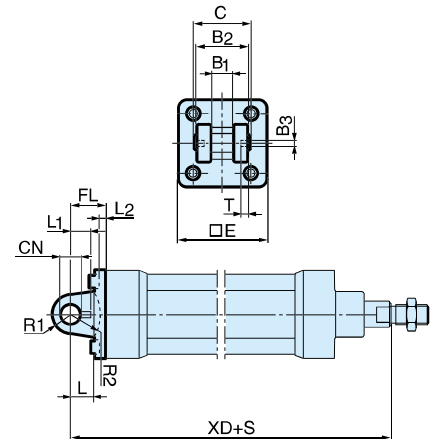

Cyl. bore mm	C mm	E mm	B2 mm	B1 mm	T mm	B3 mm	R2 mm	L1 mm	FL mm	l2 mm	L mm	CN mm	R1 mm	XD* mm	Weight (kg)	Order code	
32	41	45	34	14	3	3,3	17	11,5	22	±0,2	5,5	12	10	11	142	0,09	P1C-4KMCB
40	48	52	40	16	4	4,3	20	12,0	25	±0,2	5,5	15	12	13	160	0,13	P1C-4LMCB
50	54	65	45	21	4	4,3	22	14,0	27	±0,2	6,5	17	16	18	170	0,17	P1C-4MMCB
63	60	75	51	21	4	4,3	25	14,0	32	±0,2	6,5	20	16	18	190	0,36	P1C-4NMCB
80	75	95	65	25	4	4,3	30	16,0	36	±0,2	10,0	20	20	22	210	0,58	P1C-4PMCB
100	85	115	75	25	4	4,3	32	16,0	41	±0,2	10,0	25	20	22	230	0,89	P1C-4QMCB
125	110	140	97	37	6	6,3	42	24,0	50	±0,2	10,0	30	30	30	275	1,75	P1C-4RMCB

S = Stroke length

