

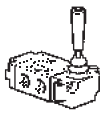

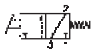



Generelle Angaben handbetätigte Ventile, Baureihe B53

mit G1/4 Anschluß

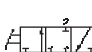
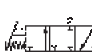
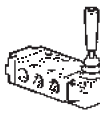
	Symbol	Typ	Betätigung	Rückstellung	Betätigungskraft bei 6 bar (N)	Gewicht (kg)	Bestell-Nr.
		3/2	Hebel	Feder	14	0,504	B53003LS
		3/2	Hebel	Pneumat.	9	0,520	B53003LP
		3/2	Hebel	Hebel	9	0,500	B53003LT
		3/3	Hebel 3 Stellungen rastend Geschl. Mittelstellung	Hebel	9	0,504	B53003L
		3/3	Hebel federzentrierte, geschl. Mittelstellung	Hebel	14	0,780	B53003LX
		5/2	Hebel	Feder	14	0,506	B53004LS
		5/2	Hebel	Pneumat.	14	0,526	B53004LP
		5/2	Hebel	Hebel	14	0,632	B53004LT
		5/3	Hebel 3 Stellungen rastend Geschl. Mittelstellung	Hebel	9	0,640	B53004L
		5/3	Hebel 3 Stellungen rastend Entlüft. Mittelstellung	Hebel	9	0,640	B53004LW
		5/3	Hebel 3 Stellungen rastend Belüft. Mittelstellung	Hebel	9	0,640	B53004LN
		5/3	Hebel federzentrierte, geschl. Mittelstellung	-	14	0,780	B53004LX
		5/3	Hebel federzentrierte, entlüft. Mittelstellung	-	14	0,780	B53004LY
		5/3	Hebel federzentrierte, belüft. Mittelstellung	-	14	0,780	B53004LZ

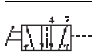
Montagesatz

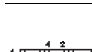
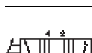
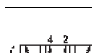
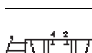
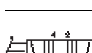
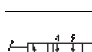
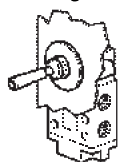

Montagesatz für Schalttafeleinbau

0,040 **M53004L-10A**

Abmessungen, Mechanisch betätigte Ventile

Mechanisch betätigte Ventile, Baureihe B53

3/2-Wege Ventile

B53003C

Stößelbetätigung mit Federrückstellung

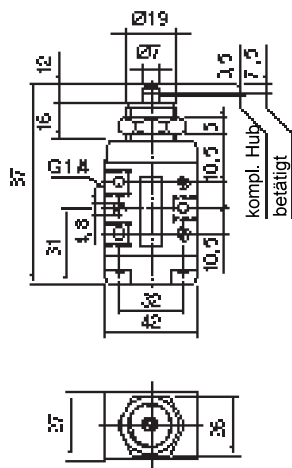

5/2-Wege Ventile

B53004C

Stößelbetätigung mit Federrückstellung

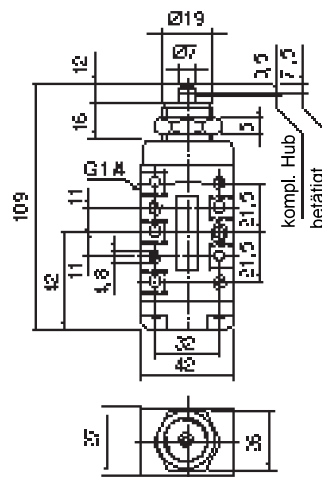

3/2-Wege Ventile

B53003R

Rollenstößelbetätigung mit Federrückstellung

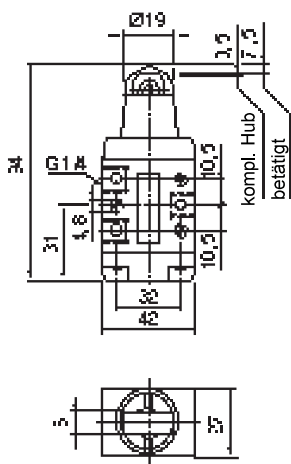

5/2-Wege Ventile

B53004R

Rollenstößelbetätigung mit Federrückstellung

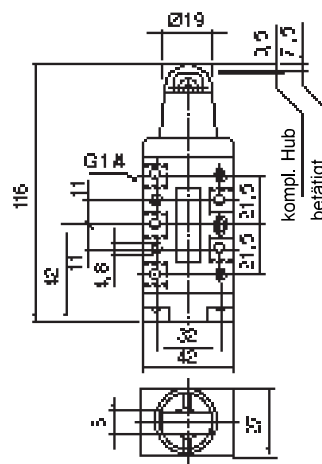

std. Federrückstellung

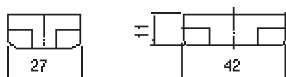

Luftfederrückstellung

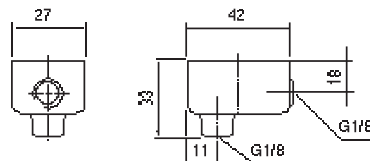

Abmessungen, G1/4-Schieberventile

Handbetätigte Ventile

3/2-Wegeventile

B53003H

Knopfbetätigt, Feder-
oder Knopfrückstellung

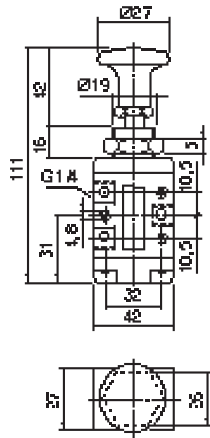

5/2-Wegeventile

B53004H

Knopfbetätigt, Feder-
oder Knopfrückstellung

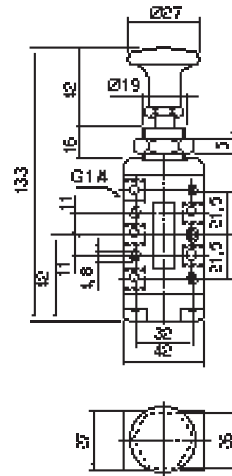

3/2-Wegeventile

B53003L

Handhebelbetätigt

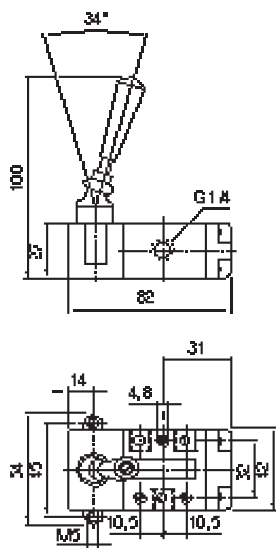

5/2-Wegeventile

B53004L

Handhebelbetätigt

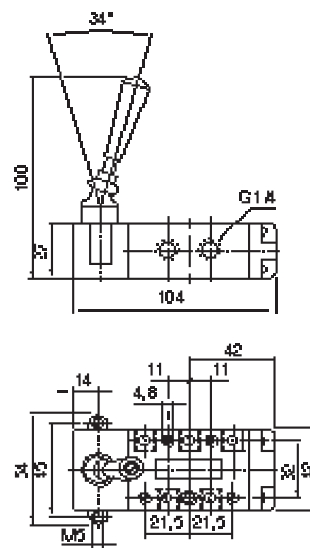

Standard Rückstellfeder

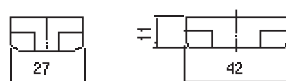

Pneumat. Rückstellung

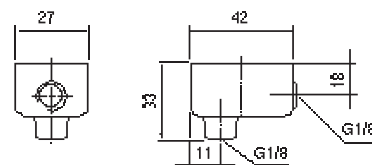

3/3-Wegeventile (federzentrierte Mittelstellung)

B53003LX

Handhebelbetätigt

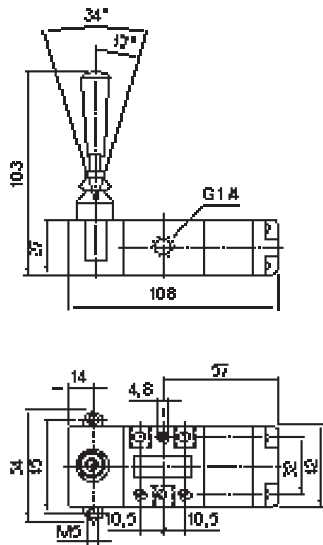

5/3-Wegeventile (federzentrierte Mittelstellung)

B53004L

Handhebelbetätigt

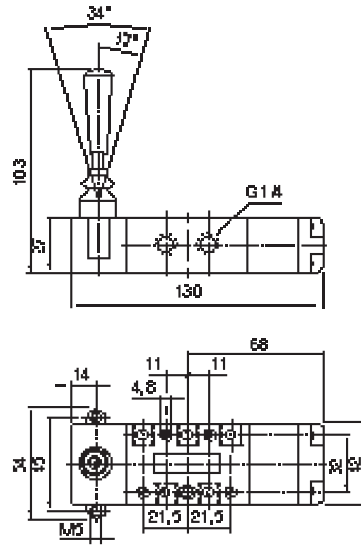

3/3 Ventile (3 Stellungen)

B53003L

Handhebelbetätigt

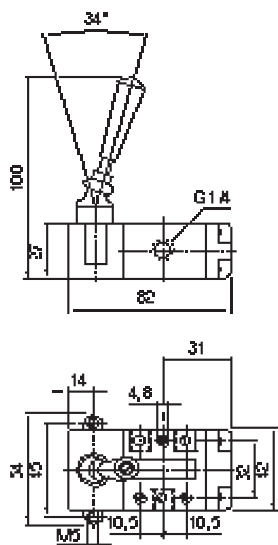

5/3-Wegeventile (3 Stellungen)

B53004L

Handhebelbetätigt

