

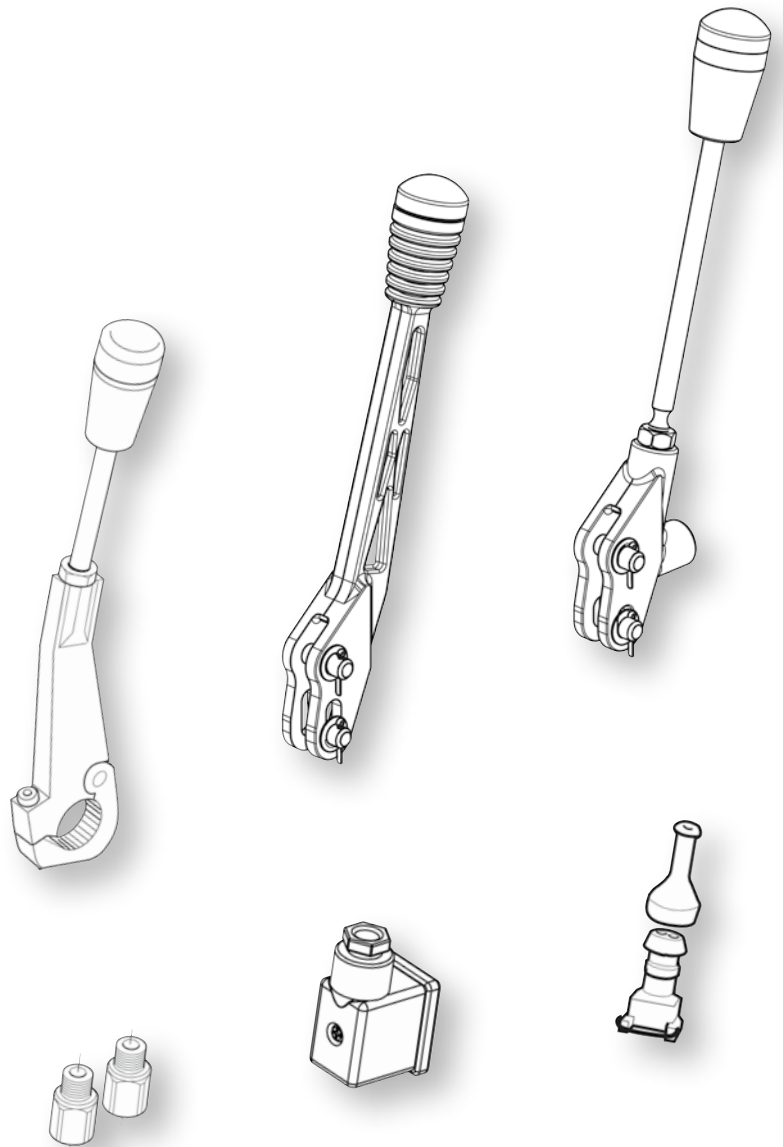

aerospace
climate control
electromechanical
filtration
fluid & gas handling
hydraulics
pneumatics
process control
sealing & shielding



Mobile Valves Accessories

Sealing Caps - Connector Kits - Hand Levers



ENGINEERING YOUR SUCCESS.



WARNING – USER RESPONSIBILITY

FAILURE OR IMPROPER SELECTION OR IMPROPER USE OF THE PRODUCTS DESCRIBED HEREIN OR RELATED ITEMS CAN CAUSE DEATH, PERSONAL INJURY AND PROPERTY DAMAGE.

This document and other information from Parker-Hannifin Corporation, its subsidiaries and authorized distributors provide product or system options for further investigation by users having technical expertise.

The user, through its own analysis and testing, is solely responsible for making the final selection of the system and components and assuring that all performance, endurance, maintenance, safety and warning requirements of the application are met. The user must analyze all aspects of the application, follow applicable industry standards, and follow the information concerning the product in the current product catalog and in any other materials provided from Parker or its subsidiaries or authorized distributors.

To the extent that Parker or its subsidiaries or authorized distributors provide component or system options based upon data or specifications provided by the user, the user is responsible for determining that such data and specifications are suitable and sufficient for all applications and reasonably foreseeable uses of the components or systems.

Offer of Sale

Please contact your Parker representation for a detailed "Offer of Sale".

Contents	Page
Sealing caps	4
Connector kits.....	4 - 5
Hand levers.....	5 - 10

Sealing caps

398000K851

Sealing cap main relief valve PB on IS or IU inlet section, P70, 500 pcs.

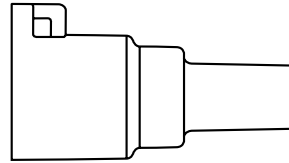

398000D853

Sealing cap pump unloading BEN, P70, 500 pcs.

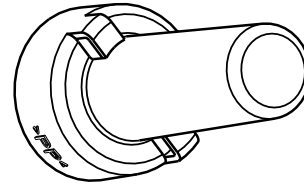

393000K852

Sealing cap, red, 1 pc. Suitable for:
K170LS, Feed reducer MR
K220LS, Feed reducer MR, Relief valve PLS
L90LS, Feed reducer MR, Main relief valve LS1 and CFC
Main relief valve PLS
P70 Main relief valve PB on I inlet section

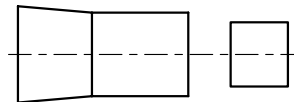

Connector kits

(Kits for connectors of Deutsch type is not available from MCDE.)

9125955110

Connector kit ACE. Suit all valves with spool actuator ACE and solenoids in version PVC102 10 pcs.

9125955125

Connector kit ACE. Suit all valves with spool actuator ACE and solenoids in version PVC102 25 pcs.

9125955150

Connector kit ACE. Suit all valves with spool actuator ACE and solenoids in version PVC102 50 pcs.

9125955199

Connector kit ACE. Suit all valves with spool actuator ACE and solenoids in version PVC102 100 pcs.



393000K825

Connector kit PVC25/PS25. Suit valves with electro hydraulic spool actuators using solenoids in version PVC25/PS25 with AMP connectors, 10 pcs.

393000K826

Connector kit PVC25/PS25. Suit valves with electro hydraulic spool actuators using solenoids in version PVC25/PS25 with AMP connectors, 50 pcs.

393000K827

Connector kit PVC25/PS25. Suit valves with electro hydraulic spool actuators using solenoids in version PVC25/PS25 with AMP connectors, 100 pcs.



393000K632

Cables for PVC25/PS25, 2m. Suit valves with electro hydraulic spool actuators using solenoids in version PVC25/PS25 with AMP connectors

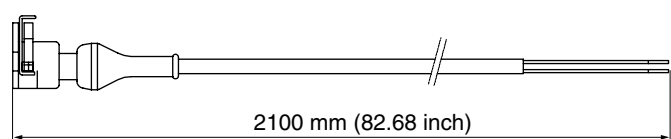

6763001

Manual override tool for PS25MO.

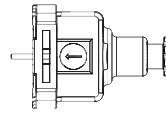

6763002

Manual override tool for PS25MO. 10 pcs

6760627 (replace 3763932)

POL. adapter G (BSPP threads). Suitable for L90LS.

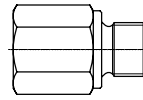

6760628 (replace 3764197)

POL. adapter U (UNF threads). Suitable for L90LS.

Hand levers

All lever pins in anodized steel. Knobs in black plastic. Oval knobs have a plastic window for placing a symbol. Where G1 or G2 is stated means valves in **Generation 1** or **Generation 2**.

9122178008

Hand lever kit **M7**. Suitable for HV07 and L90LS.

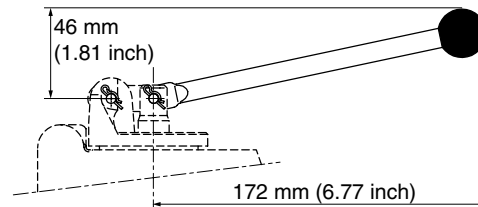

9122178011

Hand lever kit **M71**. Suitable for HV07 and L90LS.

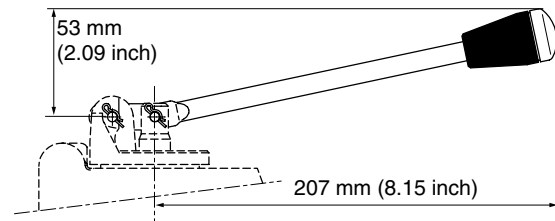

9122178014

Hand lever kit, joystick **M710**. Suitable for HV07 and L90LS.

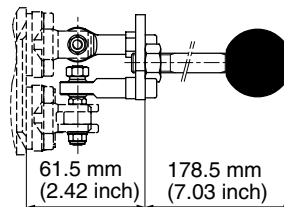

9122178015

Hand lever kit **M761**. Suitable for HV07 and L90LS.

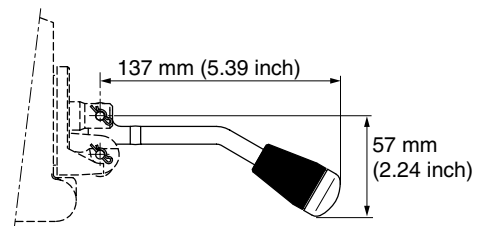

9126175701

Hand lever kit **M8**. Suitable for HV08.

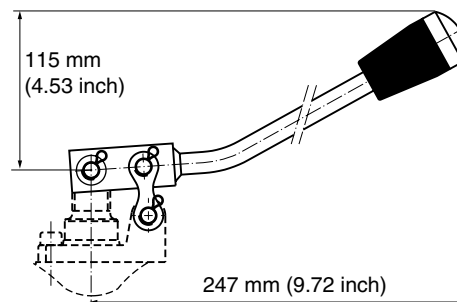

9126180901

Hand lever kit **M9**. Suitable for HV09, F130 G1 and H170CF.

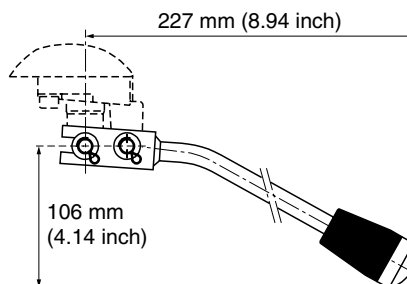

9126205201

Hand lever kit **M91**. Suitable for HV09, F130 G1 and H170CF.

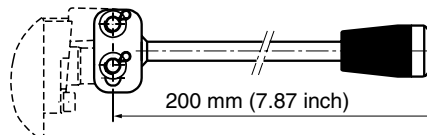

9126259201

Hand lever kit **M92**. Suitable for HV09, F130 G1 and H170CF.

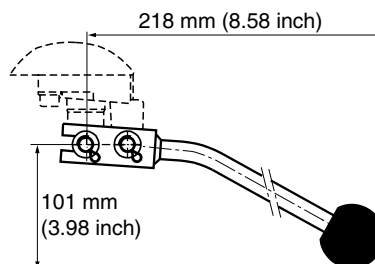

9126386055

Hand lever kit **M94**. Suitable for HV09, F130 G1 and H170CF.

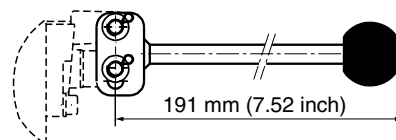

6763413

Hand lever kit, joystick **M97**. Suitable for F130 G2.

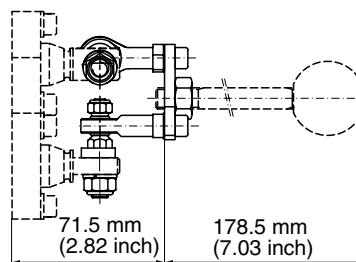

6763419

Lever kit **M97**. Suitable for F130 G2

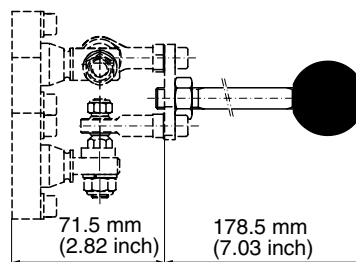

8234939001

Hand lever kit **ML1**. Suitable for L90LS, P70 and F130 G2 with ECH.

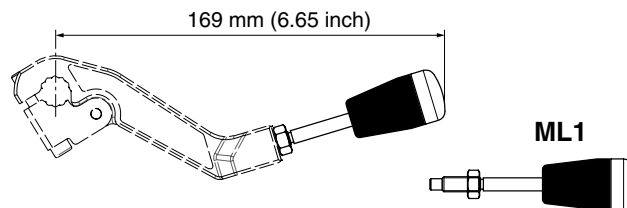

6763758

Hand lever kit **MK1**. Suitable for K220LS with ECH2, PCH.

676375825

Hand lever kit **MK1**. Suitable for K220LS with ECH2, PCH. 25 pcs

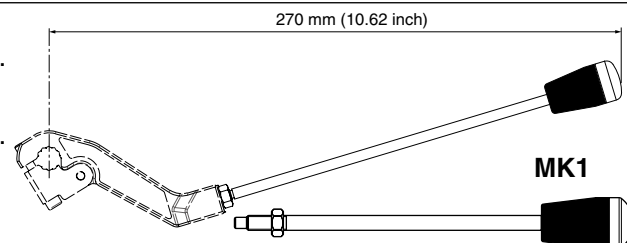

6761043

Lever kit without lever pin and knob. Suitable for P70, F130 G2 with ECH, L90LS with ECH3, ECHL3, PCH2, CH2, CHB32, K220LS with ECH2 and PCH. Can be combined with ML1

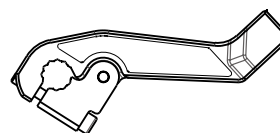

8234939021

Hand lever kit **MP1**. Suitable for P70 and F130 G2. Complete lever in plastic.

823493902125

Hand lever kit **MP1**. Suitable for P70 and F130 G2. Complete lever in plastic. 25 pcs.

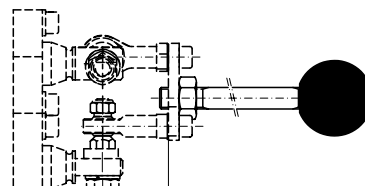

8234939022

Hand lever kit **MP2**. Suitable for P70 G1.

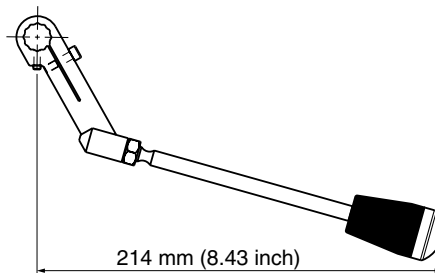

8234939091

Lever kit without lever pin and knob. Suitable for P70 G1. Can be combined with ML1

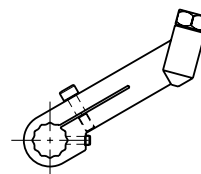

8234939023

Hand lever kit **MP3**. Suitable for P70 and F130 G2.

823493902325

Hand lever kit **MP3**. Suitable for P70 and F130 G2. 25 pcs.

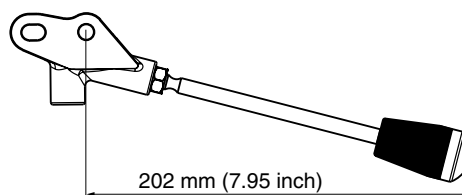

8234939026

Hand lever kit **MP6**. Suitable for P70 and F130 G2.

823493902625

Hand lever kit **MP6**. Suitable for P70 and F130 G2. 25 pcs.

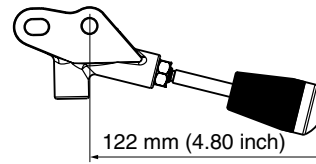

8234939027

Hand lever kit **MP7**. Suitable for P70.

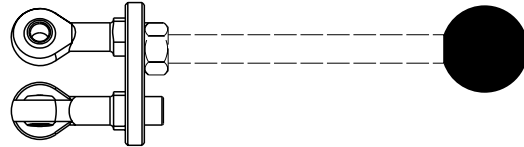

8234939028

Hand lever kit **MP8**. Suitable only in combination with MP7 for P70.

823493902825

Hand lever kit **MP8**. Suitable only in combination with MP7 for P70. 25 pcs.

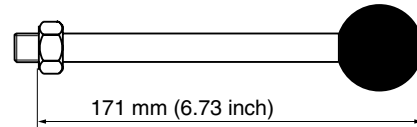

8234939029

Hand lever kit **MP9**, black knob. Suitable for P70 G1.

8234939030

Hand lever kit **MP10**, red knob. Suitable for P70 G1.

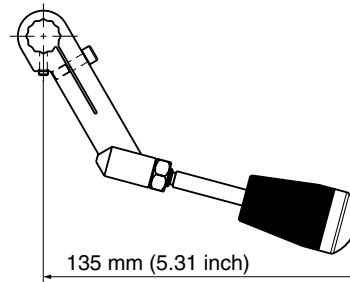

8234939031

Hand lever kit **MP11**. Suitable for P70 and F130 G2.

823493903125

Hand lever kit **MP11**. Suitable for P70 and F130 G2. 25 pcs.



8234939032

Hand lever kit **MP12**. Suitable for P70 and F130 G2.

823493903225

Hand lever kit **MP12**. Suitable for P70 and F130 G2. 25 pcs.

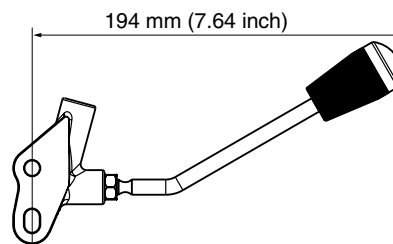

6760409

Lever kit, part of MP11
Suitable for P70 and F130 G2.

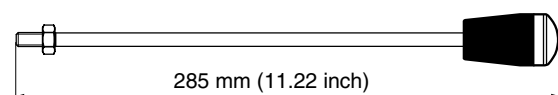

6760465

Lever kit without lever pin and knob. Part of **MP3**, **MP6**, **MP11** and **MP12**. Suitable for P70 and F130 G2.



6761044

Hand lever kit **MP13**. Suitable for P70 G2, F130 G2 with ECH, L90LS with ECH3, ECHL3, PCH2, CH2, CHB32.

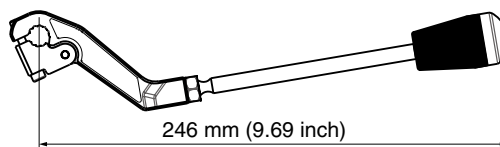

676104425

Hand lever kit **MP13**. Suitable for P70 G2, F130 G2 with ECH, L90LS with ECH3, ECHL3, PCH2, CH2, CHB32. 25 pcs.

6760951

Handle knob with window kit. Black
 Suitable for all our hand levers with oval knob.



6760955

Handle knob with window kit. Red
 Suitable for all our hand levers with oval knob.



6760546

Handle Window kit. 6 pcs
 Suitable for all our hand levers with oval knob.



6761046

Hand lever kit **MP14**, black knob. Suitable for P70 G2, F130 G2 with ECH, L90LS with ECH3, ECHL3, PCH2, CH2, CHB32.

676104625

Hand lever kit **MP14**, black knob. Suitable for P70 G2, F130 G2 with ECH, L90LS with ECH3, ECHL3, PCH2, CH2, CHB32. 25 pcs.

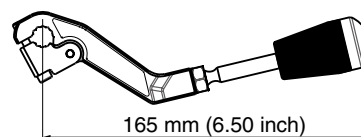

6761048

Hand lever kit **MP15**, red knob. Suitable for P70 G2, F130 G2 with ECH, L90LS with ECH3, ECHL3, PCH2, CH2, CHB32.

676104825

Hand lever kit **MP15**, red knob. Suitable for P70 G2, F130 G2 with ECH, L90LS with ECH3, ECHL3, PCH2, CH2, CHB32. 25 pcs.

6760314

Hand lever kit **MP16**.
 Suitable only in combination with MP7 for P70 G2.

Thumb switch symbol

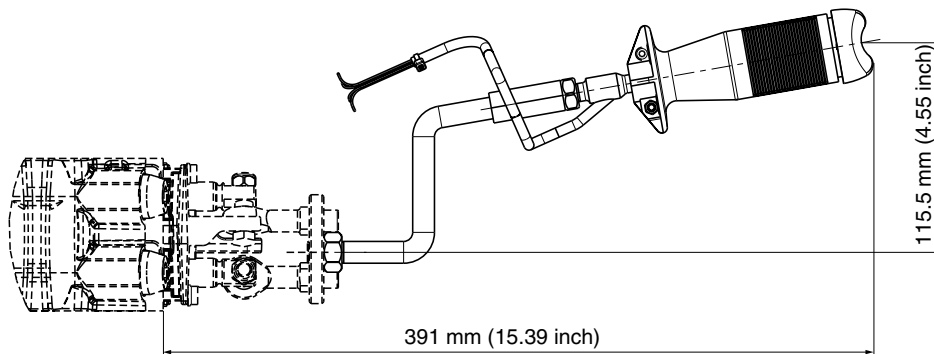
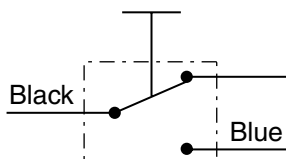

6760401

PCL402 handle typ **E1**, micro switch with IP67 class

Thumb switch symbol

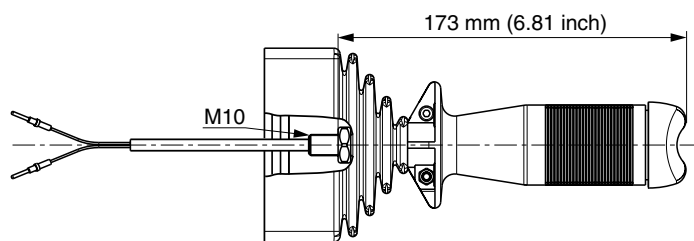
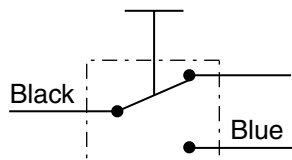

6760382

Hand lever kit **MP17**.
 Same as MP12, but reinforced lever attachment.
 Suitable for P70 and F130 G2.

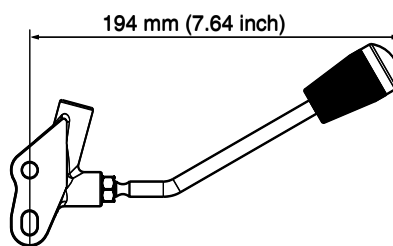

6760623

25 pcs.

6763122

Lever kit without lever pin and knob.
 Part of MP17 reinforced lever attachment.
 Suitable for P70 G2 and F130 G2.

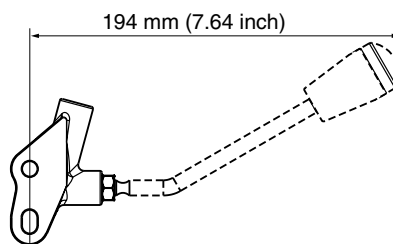

6760608

Hand lever kits **MP18**.
 Same as MP3, but all steel parts in stainless steel.
 Suitable for P70 and F130 G2.

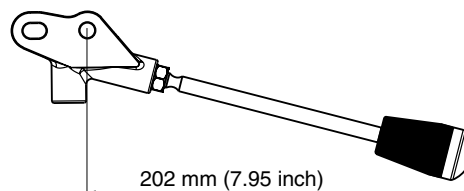

9120092540

Hand lever kit suitable for H170CF with spool actuator PCH and K170LS with spool actuator PCH, ECH and EBH.

Please note: This lever is included in the valve.
 This kit is only a Spare Part Kit, not an accessory.

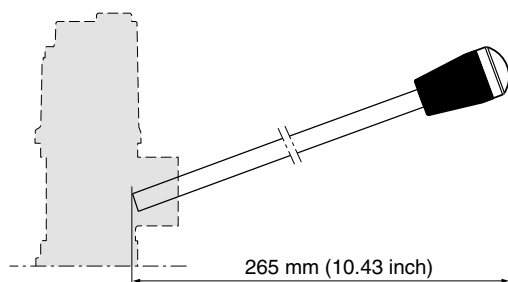

Parker Worldwide

Europe, Middle East, Africa

AE – United Arab Emirates,
Dubai

Tel: +971 4 8127100
parker.me@parker.com

AT – Austria, Wiener Neustadt
Tel: +43 (0)2622 23501-0
parker.austria@parker.com

AT – Eastern Europe, Wiener
Neustadt
Tel: +43 (0)2622 23501 900
parker.easteurope@parker.com

AZ – Azerbaijan, Baku
Tel: +994 50 22 33 458
parker.azerbaijan@parker.com

BE/LU – Belgium, Nivelles
Tel: +32 (0)67 280 900
parker.belgium@parker.com

BG – Bulgaria, Sofia
Tel: +359 2 980 1344
parker.bulgaria@parker.com

BY – Belarus, Minsk
Tel: +48 (0)22 573 24 00
parker.poland@parker.com

CH – Switzerland, Etoy
Tel: +41 (0)21 821 87 00
parker.switzerland@parker.com

CZ – Czech Republic, Klecany
Tel: +420 284 083 111
parker.czechrepublic@parker.com

DE – Germany, Kaarst
Tel: +49 (0)2131 4016 0
parker.germany@parker.com

DK – Denmark, Ballerup
Tel: +45 43 56 04 00
parker.denmark@parker.com

ES – Spain, Madrid
Tel: +34 902 330 001
parker.spain@parker.com

FI – Finland, Vantaa
Tel: +358 (0)20 753 2500
parker.finland@parker.com

FR – France, Contamine s/Arve
Tel: +33 (0)4 50 25 80 25
parker.france@parker.com

GR – Greece, Athens
Tel: +30 210 933 6450
parker.greece@parker.com

HU – Hungary, Budaörs
Tel: +36 23 885 470
parker.hungary@parker.com

IE – Ireland, Dublin
Tel: +353 (0)1 466 6370
parker.ireland@parker.com

IT – Italy, Corsico (MI)
Tel: +39 02 45 19 21
parker.italy@parker.com

KZ – Kazakhstan, Almaty
Tel: +7 7273 561 000
parker.easteurope@parker.com

NL – The Netherlands, Oldenzaal
Tel: +31 (0)541 585 000
parker.nl@parker.com

NO – Norway, Asker
Tel: +47 66 75 34 00
parker.norway@parker.com

PL – Poland, Warsaw
Tel: +48 (0)22 573 24 00
parker.poland@parker.com

PT – Portugal, Leca da Palmeira
Tel: +351 22 999 7360
parker.portugal@parker.com

RO – Romania, Bucharest
Tel: +40 21 252 1382
parker.romania@parker.com

RU – Russia, Moscow
Tel: +7 495 645-2156
parker.russia@parker.com

SE – Sweden, Spånga
Tel: +46 (0)8 59 79 50 00
parker.sweden@parker.com

SK – Slovakia, Banská Bystrica
Tel: +421 484 162 252
parker.slovakia@parker.com

SL – Slovenia, Novo Mesto
Tel: +386 7 337 6650
parker.slovenia@parker.com

TR – Turkey, Istanbul
Tel: +90 216 4997081
parker.turkey@parker.com

UA – Ukraine, Kiev
Tel: +48 (0)22 573 24 00
parker.poland@parker.com

UK – United Kingdom, Warwick
Tel: +44 (0)1926 317 878
parker.uk@parker.com

ZA – South Africa, Kempton Park
Tel: +27 (0)11 961 0700
parker.southafrica@parker.com

North America

CA – Canada, Milton, Ontario
Tel: +1 905 693 3000

US – USA, Cleveland
(industrial)
Tel: +1 216 896 3000

US – USA, Elk Grove Village
(mobile)
Tel: +1 847 258 6200

Asia Pacific

AU – Australia, Castle Hill
Tel: +61 (0)2-9634 7777

CN – China, Shanghai
Tel: +86 21 2899 5000

HK – Hong Kong
Tel: +852 2428 8008

ID – Indonesia, Tangerang
Tel: +62 21 7588 1906

IN – India, Mumbai
Tel: +91 22 6513 7081-85

JP – Japan, Fujisawa
Tel: +81 (0)4 6635 3050

KR – South Korea, Seoul
Tel: +82 2 559 0400

MY – Malaysia, Shah Alam
Tel: +60 3 7849 0800

NZ – New Zealand, Mt Wellington
Tel: +64 9 574 1744

SG – Singapore
Tel: +65 6887 6300

TH – Thailand, Bangkok
Tel: +662 186 7000

TW – Taiwan, New Taipei City
Tel: +886 2 2298 8987

VN – Vietnam, Ho Chi Minh City
Tel: +84 8 3999 1600

South America

AR – Argentina, Buenos Aires
Tel: +54 3327 44 4129

BR – Brazil, Cachoeirinha RS
Tel: +55 51 3470 9144

CL – Chile, Santiago
Tel: +56 2 623 1216

MX – Mexico, Toluca
Tel: +52 72 2275 4200



EMEA Product Information Centre

Free phone: 00 800 27 27 5374

(from AT, BE, CH, CZ, DE, DK, EE, ES, FI, FR, IE, IL, IS, IT, LU, MT, NL, NO, PL, PT, RU, SE, SK, UK, ZA)

US Product Information Centre

Toll-free number: 1-800-27 27 537

www.parker.com

Your local authorized Parker distributor