

Kommutator komplett mit neuer Dichtung einsetzen. Die flache Seite der Dichtung zeigt nach außen.

Fit commutator assembly with new seals. Assemble seal flat side out.

Remonter l'ensemble commutateur avec un nouveau joint côté plat à l'extérieur.

Montare il distributore con la nuova guarnizione con il lato piano verso l'esterno.

30...35Nm Anziehmoment wechselseitig an 5 oder 6 Schrauben.

30...35Nm torque max. 5 or 6 bolts crosswise.

30...35Nm couple moteur max. 5 ou 6 boulons réciproquement.

30...35Nm coppia di serraggio 5 o 6 bulloni.

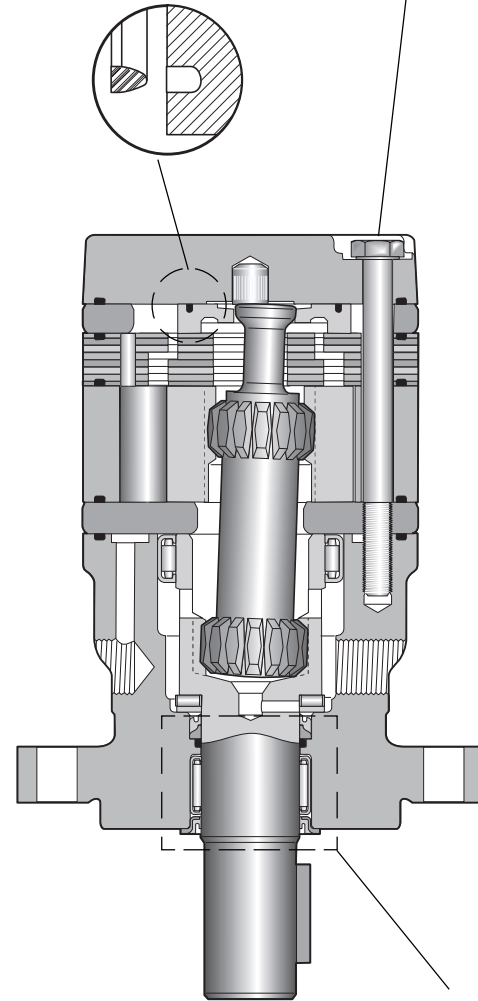

Vor dem Einbau der Abtriebswelle den Raum zwischen den gestrichelten Linien be fetten.

Apply grease to shaft OD. and ID. in area designated by dotted lines.

Avant l'assemblage de l'arbre veuillez graisser l'espace situé entre les lignes en tirets.

Prima del montaggio dell'albero pregasi lubrificare la zona evidenziata con linee tratteggiate.

Spare Parts

**Torqmotor
Series TJ**

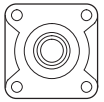
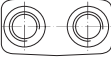
Pos. 1	
Gehäuse komplett Housing assembly Carter Scatola motore	
	MP012003J3 CODE HW
G 1/2	

Pos. 6	
Dichtsatz komplett Seal kit Jeu de joints Kit guarnizioni	SK000146 Standard

Pos. 9	
Zwischenscheibe Wear plate Plaque d'usure Piastra d'usura	477341

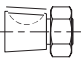
Pos. 2			Pos. 14	
Abtriebswelle / Coupling shaft Arbre / Albero uscita			Scheibenfeder Woodruff key Clavette / Chiavetta	
	1:8 1.25 inch	MP019000 CODE 08	G124554	

Pos. 10		
Verteiler Manifold Plan de pose Distributore	MF015000 Standard	CODE 0
Verteiler Manifold Plan de pose Distributore	MF015001 Reverse	CODE 1

	Pos. 3	Pos. 4	Pos. 5
Baugröße Size Taille Grandezza	Schraube / Bolt Vis / Vite	Rotor komplett Rotor set Jeu rotor Rotore	Zwischenwelle Drive link Abre d'entrain Albero entrata
36	021311	MF017003	MF013000
45	021311	MF027003	MF023000
50	021311	MF037003	MF033000
65	021306	MF047003	MF043000
80	021382	MF057003	MF053000
100	021357	MF067003	MF063000
130	021307	MF087003	MF083000
165	021358	MF107003	MF103000
195	021308	MF127003	MF123000
230	021359	MF147003	MF143000
260	021310	MF167003	MF163000
295	021383	MF187003	MF183000
330	021384	MF207003	MF203000
390	021414	MF247003	MF243000

Pos. 12	
Kommutator komplett Commutator assembly Ensemble commutateur Assieme distributore	MF018000A1

Pos. 13	
Abschlussplatte End cover Couvercle Coperchio posteriore	MF016007

Pos. 15	
Selbstsichernde Mutter Self-locking nut Ecrou nyl-stop Dado autobloccante	025126
Kronenmutter Castle nut Ecrou crénelé Tuerca	025132