

d ZL007-DS

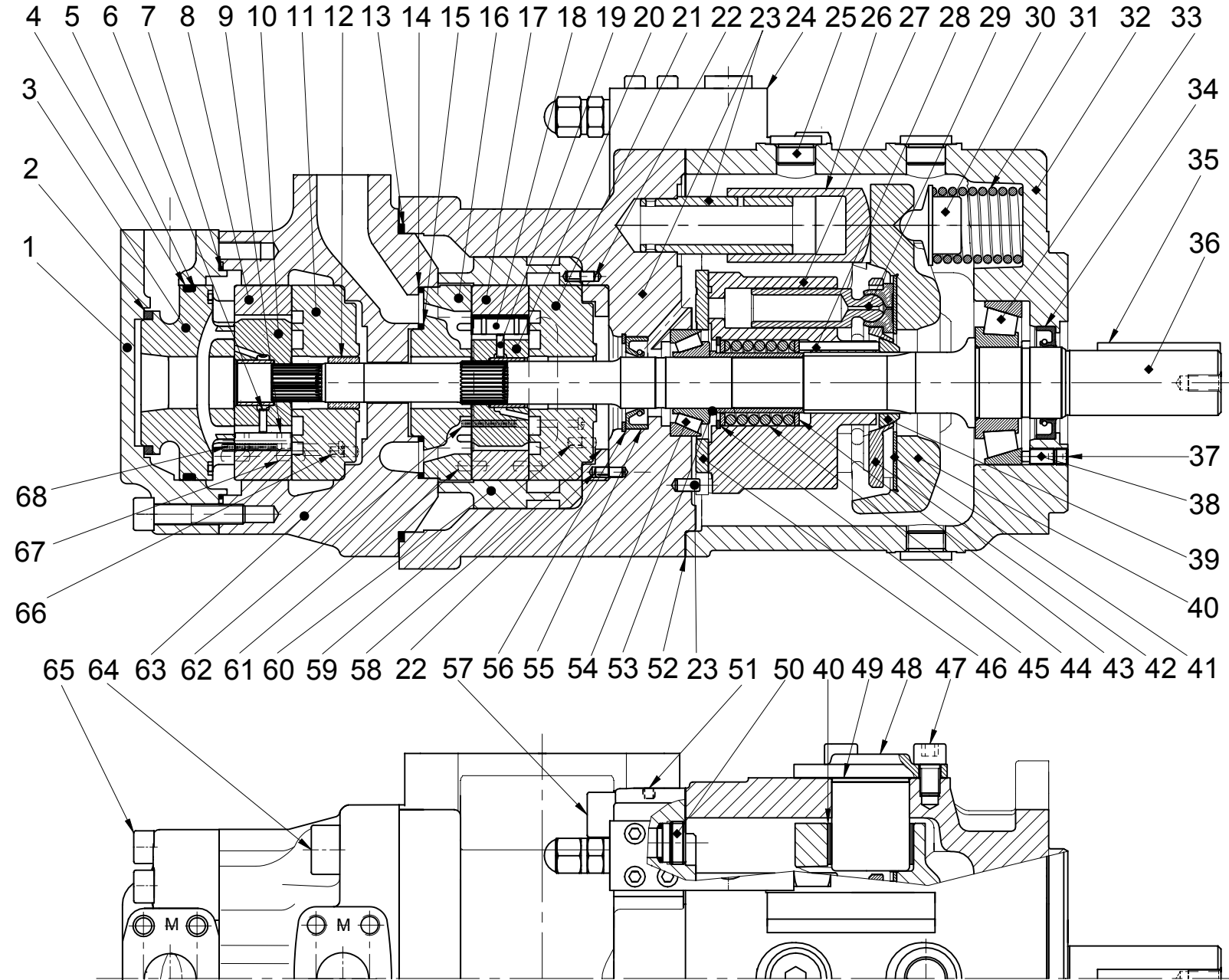

| 024-77407-0 | | T6H29BB B15 B15 1R1B 4F0M0 40 | | |
|-------------|-----|-------------------------------|-----|--------------------------------|
| item | kit | code number | qty | description |
| 1 | | 034-71327-0 | 1 | CAP T6DC END 1" MET |
| 2 | AC | 691-10229-0 | 1 | ORING ID 59.92X3.40 S1 90 SH |
| 3 | A | 034-66923-0 | 1 | PLATE T7B PRESS BI-ROT |
| 4 | AC | 691-10238-0 | 1 | ORING ID 88.49X3.40 S1 90 SH |
| 5 | AC | 618-15016-0 | 1 | RING BACKUP C SIZE BRP2107238 |
| 6 | A | 034-66991-0 | 12 | PIN T67BB VANE HOLDOUT |
| 7 | AC | 671-10156-0 | 1 | ORING ID 107.62X2.51 S1 70 SH |
| 8 | A | 034-67034-0 | 1 | CAM T7B 015 |
| 9 | A | 034-66917-0 | 12 | VANE T7B |
| 10 | A | S24-49820-0 | 1 | ROTOR T7B ASSY |
| 11 | AD | 034-66922-0 | 1 | PLATE T67CB REAR "B" BI-ROT |
| 12 | AD | 034-59412-0 | 1 | BUSH BEARG 25.4 X19.18X15 |
| 13 | BC | 691-10256-0 | 1 | ORING ID 145.64X3.40 S1 90 SH |
| 14 | BC | 691-10153-0 | 1 | ORING ID 88.57X2.51 S1 90 SH |
| 15 | BC | 691-10137-0 | 1 | ORING ID 52.07X2.51 S1 90 SH |
| 16 | B | 034-67060-0 | 1 | PLATE T67DBB PRESS BI-ROT |
| 17 | B | 034-67034-0 | 1 | CAM T7B 015 |
| 18 | B | 034-66917-0 | 12 | VANE T7B |
| 19 | B | 034-66991-0 | 12 | PIN T67BB VANE HOLDOUT |
| 20 | B | S24-51722-0 | 1 | ROTOR T67BB ASSY "B" |
| 21 | BE | 034-66922-0 | 1 | PLATE T67CB REAR "B" BI-ROT |
| 22 | | 323-82010-0 | 2 | PIN GROOV 4.76X13 |
| 23 | | S24-77459-0 | 1 | BLOCK T6H29BB CW MET ASS |
| 24 | | S24-68692-0 | 1 | CONTL PV TYPE F BSP ASS |
| 25 | | 447-01008-2 | 3 | PLUG STEEL 1/2" BSP W/S1 |
| 26 | | 034-67333-0 | 1 | PLNGR T6H29 CTL HANGER |
| 27 | F | 039-54039-0 | 1 | BARRL PV29 |
| 28 | F | 324-30020-0 | 3 | PIN DOWEL 039-57828-A |
| 29 | F | S29-01170-0 | 9 | PISTON & SHOE ASSY PV29 |
| 30 | | 039-54104-0 | 1 | SEAT PV29 SPRING HANGER |
| 31 | | 039-54099-0 | 1 | SPRNG PV29 HANGER |
| 32 | | 034-67319-0 | 1 | HOUSG T6H29 BSP TAP BRG |
| 33 | G | 230-90028-3 | 1 | BEARG ROLER 35x8x22.75 TAPR |
| 34 | C | 620-82106-0 | 1 | SEAL LIP S1 35 X 55 X11 HP |
| 35 | G | 034-66980-0 | 1 | KEY SQUARE 7.94X60 |
| 36 | G | 034-67628-0 | 1 | SHAFT T6H29BB KEYED 1 T. B. |
| 37 | | 311-60028-3 | 3 | SCREW SS FLAT PT M8x8 DIN 913 |
| 38 | | 311-60030-3 | 3 | SCREW SS M 8x12 FL PT D913 45H |
| 39 | F | 039-54258-0 | 1 | BALL PV29 HOLDDOWN PISTONS |
| 40 | | S24-68967-0 | 1 | HANGR T6H29 B MOD ASS |
| 41 | F | 039-91355-0 | 1 | PLATE PV29 WEAR |
| 42 | F | 039-54084-0 | 1 | PLATE PV29 GUIDE PISTONS |
| 43 | F | 039-54139-0 | 2 | WASHR PV29 BARREL |
| 44 | F | 039-54094-0 | 1 | SPRNG PV29 BARREL |
| 45 | F | 356-65118-0 | 1 | RING RETAIN INT BORE 42 PV29 |
| 46 | F | 034-67329-0 | 1 | PLATE T6H29 PORT CW T. B. |
| 47 | | 361-11154-8 | 6 | SCREW SHC M10X 15 D912 G12.9 |
| 48 | | 034-66982-0 | 2 | TRUNN T6H29 |
| 49 | C | 039-54133-0 | 2 | GASKT PV20 TRUNNION |
| 50 | | 513-10010-3 | 1 | VALVE CHECK "HAWK" RB3 1/2" |
| 51 | | 431-90100-0 | 1 | PLUG HEX SOC 1/16NPTF |
| 52 | C | 039-54129-0 | 1 | GASKT PV29 BLOCK |
| 53 | G | 034-67315-0 | 1 | SPACR T6H29 TAPER BEARING |
| 54 | G | 230-90029-3 | 1 | BEARG ROLER 25x5x21.25 TAPR |
| 55 | C | 620-00020-3 | 1 | SEAL LIP S1 25 X 45 X10 |
| 56 | | 356-65107-0 | 1 | RING RETAIN INT BORE 45 |
| 57 | | 361-13274-3 | 4 | SCREW SHC M14X 55 D912 G12.9 |
| 58 | | 034-67632-0 | 1 | PLATE T6H29BB SUPPORT CART. |
| 59 | E | 323-82010-0 | 1 | PIN GROOV 4.76X13 |
| 60 | | 034-67631-0 | 1 | ADAPT T6H29BB CENTER CART. |
| 61 | B | 324-21208-0 | 2 | PIN DOWEL 4.76X12.7 |
| 62 | B | 317-06266-0 | 2 | SCREW FILL 6 32NC 2 1/4 NYL |
| 63 | | 034-67630-0 | 1 | BLOCK T6H29BB PORT CENTR |
| 64 | | 361-14284-3 | 4 | SCREW SHC M16X 60 D912 G12.9 |
| 65 | | 361-11264-3 | 7 | SCREW SHC M10X 50 D912 G12.9 |
| 66 | A | 323-82010-0 | 1 | PIN GROOV 4.76X13 |
| 67 | A | 324-21208-0 | 2 | PIN DOWEL 4.76X12.7 |
| 68 | A | 317-06266-0 | 2 | SCREW FILL 6 32NC 2 1/4 NYL |

| REPAIR KIT | | TITRE | |
|------------|-------------|-------|----------------------------|
| A | S24-59011-0 | 1 | CARTRIDGE ASS B15 CW (P3) |
| B | S24-59725-0 | 1 | CARTRIDGE ASS B15 CW (P2) |
| C | S24-77460-0 | 1 | SEAL KIT S1 |
| D | S24-50642-0 | 1 | PORT PLATE REAR ASS (P3) |
| E | S24-59751-0 | 1 | PORT PLATE REAR ASS (P2) |
| F | S24-69588-0 | 1 | ROTATING GROUP CW (P1) |
| G | S24-77435-0 | 1 | SHAFT & BEARING ASS CODE 1 |

ATTENTION !
 CE PLAN Y COMPRIS LES INFORMATIONS SONT LA PROPRIETE DE DENISON HYDRAULICS VIERZON-FRANCE. IL EST LIVRE POUR LA SEULE UTILISATION DE : -

IL NE PEUT ETRE DELIVRE OU REPRODUIT POUR UNE LIBRE CIRCULATION SANS L'ACCORD ECRIT DU DEPARTEMENT ENGINEERING DE VIERZON.
 PAR : - LE : -

NON DEFINI SUR DESSIN
 1-Dimensions et tolérances suivant USA SI Y34-5-1966 ou APPROX NF E 04-922;
 2-Etat de surface 12.5µm (Ra 3,2)
 3-Tolérances pour surfaces usinées :
 - Casage d'angles 0,25 - rayon intérieur 0,760/0,127
 1 décimale ±0,25 - 2 décimales ±0,13;
 4-Angles α 1/2°;
 5-Tolérances perçage de trous suivant n°41.6
 6-Tolérances de fonderie suivant SA-9347
 7-Autres: voir notes

MATIERE : -

DESSINE EN CAO

ET. -
 DES. L.M.
 VER. -
 DATE : 28-Jan-02
 ECH. : 1
 POIDS ESTIME 79 Kg
 PLAN DE 1/1

DENISON Hydraulics
 VIERZON FRANCE

**TRIPLE HYBRID PUMP
 T6H29BB**

SD-70072