

EHV Series: How to order a high pressure accumulator

EHV 24 5- 330 /90-A25GA-200/100

Product Type

- EHV** High pressure bladder
- ETHV** High pressure transfer bladder
- EHVF** High pressure bladder flanger

Volume in L (up to 4 Characters)

- 0,2 for 0,5 Liter
- 20 for 20 Liters
- 24,5 for 24.5 Liters

Maximum Working Pressure

- 120 for 120 bar max working pressure (stainless steel range)
- 330 for 330 bar max working pressure
- 350** for 350 bar max working pressure
- 690 for 690 bar max working pressure

*If the product is not CE, use highest MWP according to regulation relevant to the product (see Approvals PAGES 64&65)

Approvals*

- 0 According to the PED2014/68/EU, article 4.3 for the volumes from 0.5 to 1L
- 48 According ASME
- 71 According CUTR 032/2013
- 86 According CE/ASME/SELO
- 88 According CE/SELO
- 90** According to the PED 2014/68/EU
- 94 According CE/ASME
- * (Please refer to Approvals PAGES 63&64)

Material (Shell and Fluid Port)

- A** All parts in carbon steel with Epoxy paint for shell only
- B Carbon Steel shell + Internal Protection Epoxy 80 µm + stainless steel fluid port and valve
- C Carbon Steel shell + Int- Ext Protection Kanigen 50 µm + stainless steel fluid port and valve
- D Carbon Steel shell + Int- Ext Protection Blue Rilsan 200-300 µm + carbon steel fluid port and valve
- E Carbon Steel shell + stainless steel fluid port and valve
- F Carbon steel shell + Internal Protection Teflon 40-50 µm
- I All parts in stainless steel
- R Carbon Steel shell + Int- Ext Protection Blue Rilsan 200-300 µ + stainless steel fluid port and valve
- Z Special

Bladder Mix

- 02 For Mix 02 [-32°C;+115°C] Hydrin C
- 10 For Mix 10 [-30°C;+70°C] Nitrile Low Temperature
- 20 For Mix 20 [-6°C;+110°C] Nitrile Heavy Duty
- 25** For Mix 25 [-20°C;+100°C] Nitrile standard
- 30 For Mix 30 [-5°C;+115°C] Nitrile Low Permeability
- 35 For Mix 35 [0°C;+130°C] Nitrile high temperature
- 37 For Mix 37 [-59°C;+110°C] Nitrile Extreme Low Temp
- 40 For Mix 40 [-15°C;+120°C] Butyl
- 47 For Mix 47 [-40°C;+120°C] EPDM
- 80 For Mix 80 [-20°C;+140°C] Viton

Fluid Port Configuration

- | | | | | | |
|----------|---|---|--|---|--|
| A | Gas cyl. 1/2" (max flow rate: 120L/min | G | Gas cyl. 2" (max flow rate: 900L/min) | R | Flange BR 400-38 (max flow rate: 900L/min, EHV 10L to 57L) |
| B | Gas cyl. 3/4" (max flow rate: 240L/min | H | Gas cyl.2" DA (max flow rate: 1200L/min) | S | Flange BR 400-25 (max flow rate: 450L/min, EHV 2,5L to 10L) |
| C | Gas cyl. 1" (max flow rate: 360L/min | J | Gas cyl.2" 1/2 GD (max flow rate 1800 L/min) | Z | Special |
| D | Gas cyl. 1"1/4" (max flow rate: 450L/min | M | Metric M40 x1.5 | | |
| E | Gas cyl. 1"1/4" DA (max flow rate: 570L/min | N | Metric M50 x1.5 | | |

Gas Valve Configuration

- | | | | |
|----------|--|---|---|
| 0 | No gas valve | F | Gas Valve Type - 5/8" - 18 UNF + Burst disc |
| A | Gas Valve Type - 5/8" - 18 UNF | G | Gas Valve Type - 7/8" - 14 UNF + Burst disc |
| B | Gas Valve Type - 7/8" - 14 UNF | H | Gas Valve Type- 7/8" -14 UNF integrated + Burst disc |
| C | Gas Valve Type- 7/8" -14 UNF integrated | I | Gas Valve Type - 5/8" - 18 UNF integrated + Burst disc |
| D | Gas Valve Type - 5/8" - 18 UNF integrated | J | Gas Valve Type- 7/8" -14 UNF high pressure + Burst disc |
| E | Gas Valve Type- 7/8" -14 UNF high pressure | Z | Special |

Fluid Type

- 0 Not applicable
- 1 Fluid Type 1 CE Fluid Group 1
- 2** Fluid Type 2 - CE Fluid Group 2

Special

- | | | | | |
|-----------|---|----|--|--|
| 00 | No Special features or configuration | D1 | Standard documentation + Leak test report | <i>ASME certified accumulator according to ASME VIII Div.1 :</i> |
| EX | ATEX | D2 | Standard documentation + Descriptive statement + Design calculation note | |
| EZ | ATEX with other special configuration | ZZ | Special configuration or several options | |
| EU | All components sourced in EU | 30 | MWP = 3000 psi (207 bar) | |
| SP | Special painting | 36 | MWP = 3600 psi (248 bar) | |
| | | 40 | MWP = 4000 psi (276 bar) | |
| | | 50 | MWP = 5000 psi (345 bar) | |

Precharge @ 20°C in Bar

When at storage pressure (Keep empty)

- 100** When at storage (keep empty) example for 100 Bar precharge

EHV Series 350 bar, 0.2 to 10 Litres

Standard Version (Carbon Steel shell/NBR mix) for mineral oils.
 According to PED 2014/68/EU (**), EN 14359, Fluid Group 2
 Product Prices, Part numbers, Accessories

Type Part number	Valve see drawing	Pre-charge			Adaptor Threaded Part number	Clamps Model (quantity) Part number	Support Bracket Model Part number	Mounting Frame Model Part number	Lifting Eye on gas side Model Part number	Complete Repair Kit Model Part number
		1 - 109 bar	110 - 209 bar	210 - 300 bar						
EHV 0.2-350/00-A20AD-200* 10876301120	D	751013	751028	751043	G 1/4" cyl 4556500223	A56 (1) 20149203625				KIT EHV 0.2-350/00-A20AD 19001000220
EHV 0.5-350/00-A25BD-200* 10876401125	D	751000	751029	751044	G 3/8" cyl 4556400223	E95 (1) 20250803648				KIT EHV 0.5-350/00-A25BD 19001100225
EHV 1-350/00-A25BC-200* 10845601125	C				G 3/8" cyl	E114 (1)	CE 89			KIT EHV 1-350/00-A25BC 19029700225
EHV 1-350/00-A25BB-200* 10866901125	B	751001	751030	751045	04556400223	20251003648	20151903620			KIT EHV 1-350/00-A25BB 19036400225
EHV 1.6-350/90-A25BC-200 10998301125	C				G 3/8" cyl	E114 (1)	CE 89			KIT EHV 1.6-350/90-A25BC 19060700225
EHV 1.6-350/90-A25BB-200 11123501125	B	751014	751019	751034	04556400223	20251003648	20151903620			KIT EHV 1.6-350/90-A25BB 19061000225
EHV 2.5-350/90-A25DC-200 10854701125	C				G 3/4" cyl	E114 (2)	CE 89			KIT EHV 2.5-350/90-A25DC 19029800225
EHV 2.5-350/90-A25DB-200 10866601125	B	751002	751031	751046	04555200223	20251003648	20151903620	10912700200		KIT EHV 2.5-350/90-A25DB 19036500225
EHV 4-350/90-A25DC-200 10845401125	C				G 3/4" cyl	E168 (1)	CE108	EF1		KIT EHV 4-350/90-A25DC 19029900225
EHV 4-350/90-A25DB-200 10866101125	B	751012	751020	751035	04555200223	20251303648	20118703620	20217500125	10912700200	KIT EHV 4-350/90-A25DB 19036600225
EHV 5-350/90-A25DC-200 10861201125					G 3/4" cyl	E114 (2)	CE 89			KIT EHV 5-350/90-A25DC 19030000225
EHV 5-350/90-A25DB-200 10866701125	B	751003	751032	751047	04555200223	20251003648	20151903620	10912700200		KIT EHV 5-350/90-A25DB 19036700225
EHV 6-350/90-A25DC-200 10857401125	C				G 3/4" cyl	E168 (2)	CE108	EF1		KIT EHV 6-350/90-A25DC 19030100225
EHV 6-350/90-A25DB-200 10866201125	B	751015	751021	751036	04555200223	20251303648	20118703620	20217500125	10912700200	KIT EHV 6-350/90-A25DB 19036800225
EHV 10-350/90-A25DC-200 10859701125	C				G 3/4" cyl	E168 (2)	CE108	EF1		KIT EHV 10-350/90-A25DC 19030200225
EHV 10-350/90-A25DB-200 10866301125	B	751004	751022	751037	04555200223	20251303648	20118703620	20217500125	10912700200	KIT EHV 10-350/90-A25DB 19036900225

* From 07/2016 PED 97/23/EC Article 3.3 becomes PED 2014/68/EU Article 4.3

** From 07/2016 PED 97/23/EC becomes PED 2014/68/EU

*** For more adaptor options see page 58.

Model of valve stem
 7/8" 14 UNF
 (B)



Model of valve stem
 integrated
 7/8" 14 UNF
 (C)

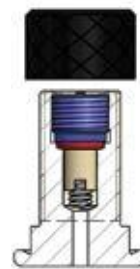

Model of valve stem
 integrated
 5/8" 18 UNF
 (D)



Type Part number	Effective Gas vol. Litres	Max. Working pressure (PS) bar	Max Flow Rate l/min	Admissible Accumulator Temperature min/max (°C) (1)	Weight kg	Gas connection	Dimensions in mm							
							A max Height	B	C	øD	ød	øE	F on flats	G connection
EHV 0.2-350/00-A20AD-200* 10876301125	0.17	350	120	- 6/+80	2.5	5/8" 18 UNF	268	38	27	58	16	39	24	G 1/2"
EHV 0.5-350/00-A25BD-200* 10876401125	0.6	350	240	- 20/+80	3	5/8" 18 UNF	260	54	27	91	16	50	32	G 3/4"
EHV 1-350/00-A25BC-200* 10845601125	1	350	240	- 20/+80	6	7/8" 14 UNF	330	54	66	116	22.5	50	32	G 3/4"
EHV 1-350/00-A25BB-200* 10866901125						7/8" 14 UNF								
EHV 1.6-350/90-A25BC-200 10998301125	1.6	350	240	- 20/+80	8	7/8" 14 UNF	442	54	66	116	22.5	50	32	G 3/4"
EHV 1.6-350/90-A25BB-200 11123501125						7/8" 14 UNF								
EHV 2.5-350/90-A25DC-200 10854701125	2	350	450	- 20/+80	11	7/8" 14 UNF	549	66	66	116	22.5	68	50	G 1 1/4"
EHV 2.5-350/90-A25DB-200 10866601125						7/8" 14 UNF								
EHV 4-350/90-A25DC-200 10845401125	3.7	350	450	- 20/+80	15	7/8" 14 UNF	434	65	66	170	22.5	68	50	G 1 1/4"
EHV 4-350/90-A25DB-200 10866101125						7/8" 14 UNF								
EHV 5-350/90-A25DC-200 10861201125	5	350	450	- 20/+80	17	7/8" 14 UNF	898	66	66	116	22.5	68	50	G 1 1/4"
EHV 5-350/90-A25DB-200 10866701125						7/8" 14 UNF								
EHV 6-350/90-A25DC-200 10857401125	6.0	350	450	- 20/+80	20	7/8" 14 UNF	560	65	66	170	22.5	68	50	G 1 1/4"
EHV 6-350/90-A25DB-200 10866201125						7/8" 14 UNF								
EHV 10-350/90-A25DC-200 10859701125	10	350	450	- 20/+80	31	7/8" 14 UNF	825	65	66	170	22.5	68	50	G 1 1/4"
EHV 10-350/90-A25DB-200 10866301125						7/8" 14 UNF								

(1)Temperature range can change depending on shell and elastomer material. Please see bladder materials and Type (page 67)

Above dimensions are in mm and are subject to manufacturing tolerances.

