

PVP, pump side module

| Code no. 157B.... |  | Without pilot supply |                                | With pilot supply |                               |   |   |
|-------------------|--|----------------------|--------------------------------|-------------------|-------------------------------|---|---|
|                   |  | for PVE              | for PVE with facilit. for PVPX | for PVE           | for PVE and facilit. for PVPX | for PVE and pilot oil pressure take-off | for PVH and pilot oil pressure take-off |
| Open centre       | P = G 1/2, T = G 3/4                   | 5000                 | -                              | 5010              | 5012                          | -                                       | -                                       |
|                   | P = 7/8 in - 14, T = 1 1/16 in - 12    | 5200                 | -                              | 5210              | 5212                          | -                                       | -                                       |
|                   | P = G 3/4, T = G 3/4                   | 5100                 | 5102                           | 5110              | 5112                          | 5180                                    | 5190                                    |
|                   | P = 1 1/16 in - 12, T = 1 1/16 in - 12 | 5300                 | -                              | 5310              | 5312                          | 5380                                    | 5390                                    |
| Closed centre     | P = G 1/2, T = G 3/4                   | 5001                 | -                              | 5011              | 5013                          | -                                       | -                                       |
|                   | P = 7/8 in - 14, T = 1 1/16 in - 12    | 5201                 | -                              | 5211              | 5213                          | -                                       | -                                       |
|                   | P = G 3/4, T = G 3/4                   | 5101                 | 5103                           | 5111              | 5113                          | 5181                                    | 5191                                    |
|                   | P = 1 1/16 in - 12, T = 1 1/16 in - 12 | 5301                 | -                              | 5311              | 5313                          | 5381                                    | 5391                                    |
| Weight            | kg [lb]                                | 3.0 [6.6]            | 3.0 [6.6]                      | 3.0 [6.6]         | 3.0 [6.6]                     | 3.0 [6.6]                               | 3.0 [6.6]                               |

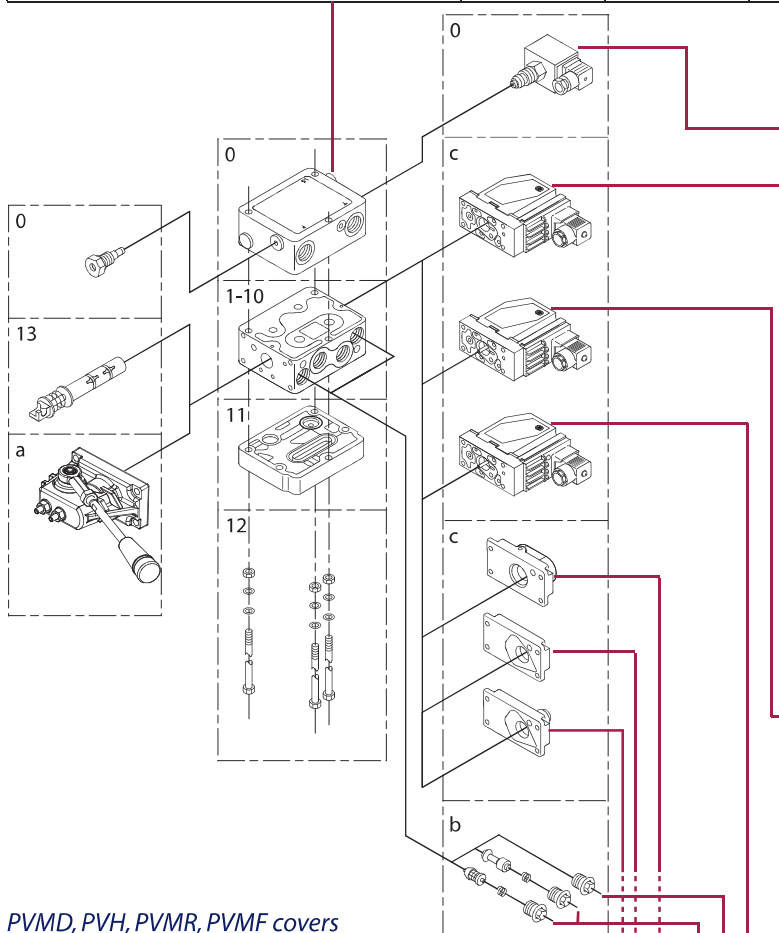

PVPX, electrical LS pressure relief valves

| Code no. 157B....                  | Code No. | Weight kg | Weight [lb] |
|------------------------------------|----------|-----------|-------------|
| Normally open                      | 12 V     | 4236      | 0.3         |
|                                    | 24 V     | 4238      | 0.3         |
| Normally closed                    | 12 V     | 4246      | 0.3         |
|                                    | 24 V     | 4248      | 0.3         |
| Normally open with manual override | 12 V     | 4256      | 0.3         |
|                                    | 24 V     | 4258      | 0.3         |
| Plug                               | 26 V     | 4260      | 0.3         |
|                                    |          | 5601      | 0.06        |

PVE, electrical actuation

| Code no. 157B....               | Code No. |      |       | Weight kg [lb] |           |
|---------------------------------|----------|------|-------|----------------|-----------|
|                                 | Hir.     | AMP  | Deut. |                |           |
| PVEO, on-off                    | 12 V     | 4216 | 4901  | 4291           | 0.6 [1.3] |
|                                 | 24 V     | 4228 | 4902  | 4292           | 0.6 [1.3] |
| PVEO-R, on/off                  | 12 V     | 4217 | 4903  | -              | 0.6 [1.3] |
|                                 | 24 V     | 4229 | 4904  | -              | 0.6 [1.3] |
| PVEM, prop. medium - Standard   | 12 V     | 4116 | -     | -              | 0.9 [2.0] |
|                                 | 24 V     | 4128 | -     | -              | 0.9 [2.0] |
| PVEM, prop. medium - Float -> B | 12 V     | 4416 | -     | -              | 1.0 [2.2] |
|                                 | 24 V     | 4428 | -     | -              | 1.0 [2.2] |
| PVEA, active fault mon.         | -        | 4734 | 4792  | -              | 0.9 [2.0] |
| PVEA, passive fault mon.        | -        | 4735 | -     | -              | 0.9 [2.0] |
| PVEA-DI, active fault mon.      | -        | 4736 | 4796  | -              | 0.9 [2.0] |
| PVEA-DI, passive fault mon.     | -        | 4737 | -     | -              | 0.9 [2.0] |
| PVEH active fault mon.          | 4032     | 4034 | 4092  | -              | 1.0 [2.2] |
| PVEH passive fault mon.         | 4033     | 4035 | 4093  | -              | 1.0 [2.2] |
| PVEH float -> B, act. fault     | 4332     | -    | 4392  | -              | 1.0 [2.2] |
| PVEH float -> A, act. fault     | -        | 4338 | -     | -              | 1.0 [2.2] |
| PVEH- DI active fault mon.      | -        | 4036 | 4096  | -              | 1.0 [2.2] |
| PVEH - DI passive fault mon.    | -        | 4037 | -     | -              | 1.0 [2.2] |
| PVES, active fault mon.         | 4832     | 4834 | 4892  | -              | 1.0 [2.2] |
| PVES, passive fault mon.        | 4833     | 4835 | -     | -              | 1.0 [2.2] |

PVMD, PVH, PVMR, PVMF covers

| Code no. 157B....                     | Code No. | Weight kg | Weight [lb] |
|---------------------------------------|----------|-----------|-------------|
| PVMR (frict. detent)                  | 0004     | 0.3       | 0.6         |
| PVMF (mech. float position)           | 0005     | 0.3       | 0.6         |
| Cover for PVM                         | 0001     | 0.1       | 0.2         |
| Hydraulic actuation PVH 9/16 - 18 UNF | 0007     | 0.9       | 2.0         |
| Hydraulic actuation PVH G 1/4         | 0008     | 0.2       | 0.4         |

PVLA, anti-cavitation valve

| Code no. 157B.... | Code No. | Weight |      |
|-------------------|----------|--------|------|
|                   |          | kg     | [lb] |
| Plug A or B       | 2002     | 0.04   | 0.09 |
| Valve A or B      | 2001     | 0.05   | 0.1  |