

Alle rätigheter förbehålls.
All rights reserved.
Alle Rechte vorbehalten.

Diese Zeichnung darf weder ganz noch teilweise ohne unsere ausdrückliche Genehmigung kopiert oder auf andere Weise vervielfältigt werden. Werden. Zuwiderhandlungen werden gerichtlich verfolgt.

Denna handling får ej utan vårt medgivande delges annan. Kopieras eller eljest obehörigen användas. Överräddelse härvid beivras med stöd av gällande lag. This document must not be copied, either completely or in part, without permission. Any infringement will have legal consequences.

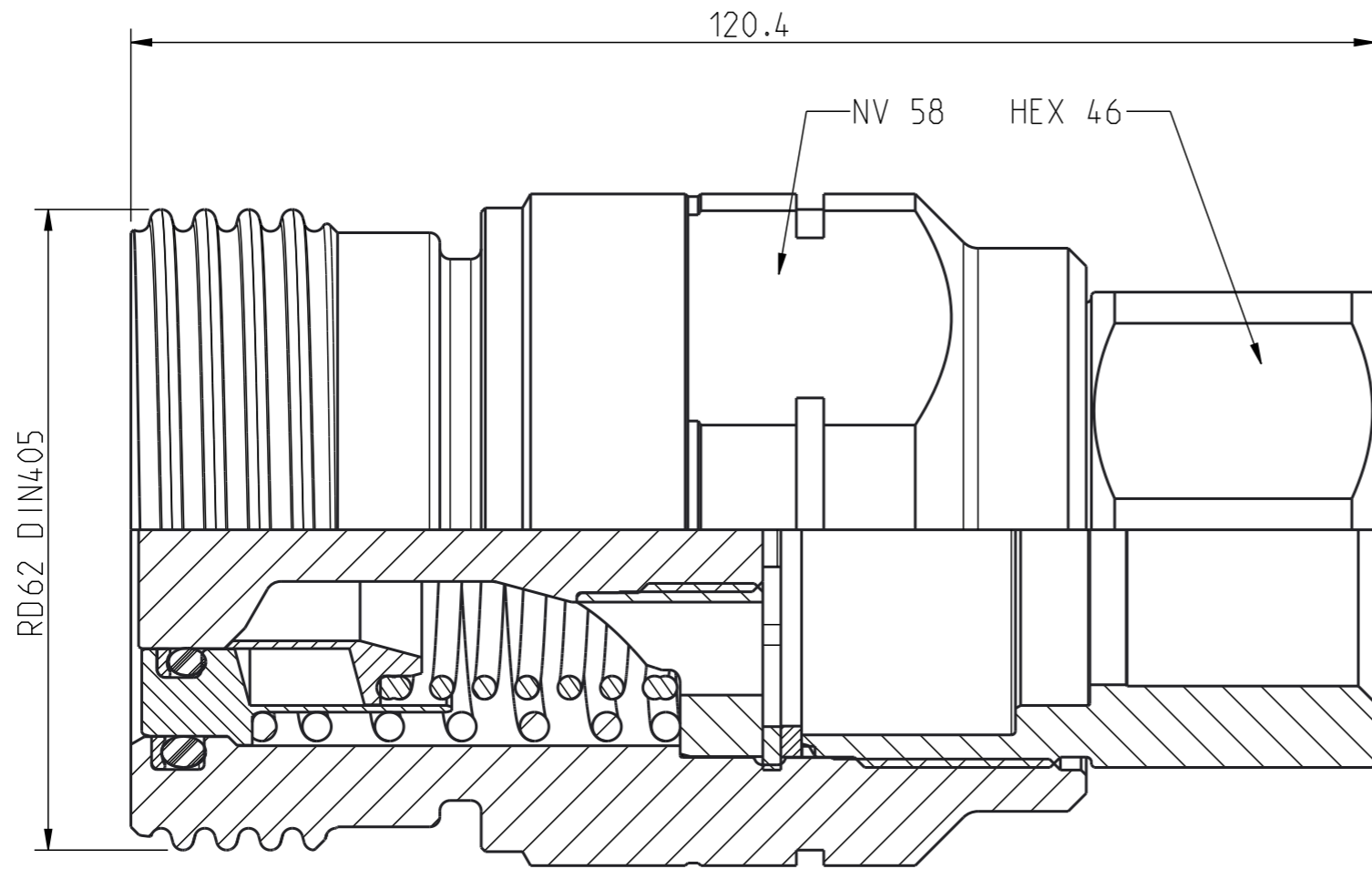
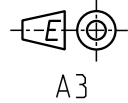

Product no: 10_707_1203		
Max working pressure:	400 bar connected	330 bar disconnected
Min burst pressure:	1600 bar connected	990 bar disconnected
Sealing material:	NBR	
Temperatur range:	-30°C - +100 °C	
Nominal flow diameter, DN:	mm	
Connection	G 1" fem	
Connection stroke:	mm	

15	1	Washer	Steel
14	1	Valve sleeve	Steel
13	1	Valve opener	Steel harden. Zn-Ni 9 transp
12	1	Valve	Steel, Zn-Ni 9 transp
11	1	Stop for valve	Steel
10	1	Spring	Steel
9	1	Spring	Stainless steel
8	1	O-ring	NBR
7	1	O-ring	NBR
6	1	Lock ring	Steel
5	1	Flat seal	Plastic
4	1	Coupling body	Steel hard. Zn-Ni 9 transp
3	1	Back up ring	POM
2	1	Back up ring	POM
1	1	Back part	Steel, Zn-Ni 9 transp
Detalj Item	Antal Quant.	Benämning Description	Material Material

CEJN	Skala Scale	2:1	Ritad Drawn	CABMBA	Kontroll. Checked	PeOd	Godk. Appr.	PMB	Äm nr. Alt. no.	10586	Dat. Date	13-11-06
	Assembly drawing							Ritning nr./Drawing No.		50_707_1203		Utg./Issue