

**FM EO2-Funktionsmutter**

für Stahl-Rohr

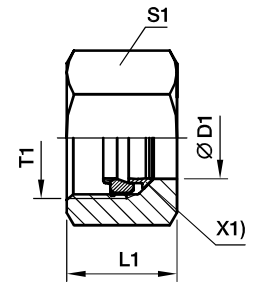

X1) Haltering

Bau- reihe	D1 	T1	L1	S1	Bestellzeichen				Gewicht g/1 St.
					FM...CF Stahl verzinkt Cr(VI) frei passiv. + Versiegelung		FM...VITCF Stahl verzinkt Cr(VI) frei passiv. + Versiegelung		
					Dichtung NBR	PN (bar)	Dichtung FKM	PN (bar)	
LL	04	M 08×1.0	11.0	10	<b>FM04LLCF</b>	100	—	100	5
	06	M 10×1.0	11.5	12	—	—	—	—	6
L	06	M 12×1.5	14.5	14	<b>FM06LCF</b>	500	<b>FM06LVITCF</b>	500	12
	08	M 14×1.5	14.5	17	<b>FM08LCF</b>	500	<b>FM08LVITCF</b>	500	17
	10	M 16×1.5	15.5	19	<b>FM10LCF</b>	500	<b>FM10LVITCF</b>	500	22
	12	M 18×1.5	15.5	22	<b>FM12LCF</b>	400	<b>FM12LVITCF</b>	400	30
	15	M 22×1.5	17.0	27	<b>FM15LCF</b>	400	<b>FM15LVITCF</b>	400	48
	18	M 26×1.5	18.0	32	<b>FM18LCF</b>	400	<b>FM18LVITCF</b>	400	70
	22	M 30×2.0	20.0	36	<b>FM22LCF</b>	250	<b>FM22LVITCF</b>	250	94
	<b>28</b>	<b>M 36×2.0</b>	<b>21.0</b>	<b>41</b>	<b>FM28LCF</b>	<b>250</b>	<b>FM28LVITCF</b>	<b>250</b>	<b>106</b>
	35	M 45×2.0	24.0	50	<b>FM35LCF</b>	250	<b>FM35LVITCF</b>	250	160
	42	M 52×2.0	24.0	60	<b>FM42LCF</b>	250	<b>FM42LVITCF</b>	250	244
S	06	M 14×1.5	16.5	17	<b>FM06SCF</b>	800	<b>FM06SVITCF</b>	800	20
	08	M 16×1.5	16.5	19	<b>FM08SCF</b>	800	<b>FM08SVITCF</b>	800	23
	10	M 18×1.5	17.5	22	<b>FM10SCF</b>	800	<b>FM10SVITCF</b>	800	37
	12	M 20×1.5	17.5	24	<b>FM12SCF</b>	630	<b>FM12SVITCF</b>	630	39
	14	M 22×1.5	20.5	27	<b>FM14SCF</b>	630	<b>FM14SVITCF</b>	630	60
	16	M 24×1.5	20.5	30	<b>FM16SCF</b>	630	<b>FM16SVITCF</b>	630	72
	20	M 30×2.0	24.0	36	<b>FM20SCF</b>	420	<b>FM20SVITCF</b>	420	121
	25	M 36×2.0	27.0	46	<b>FM25SCF</b>	420	<b>FM25SVITCF</b>	420	221
	30	M 42×2.0	29.0	50	<b>FM30SCF</b>	420	<b>FM30SVITCF</b>	420	248
	38	M 52×2.0	32.5	60	<b>FM38SCF</b>	420	<b>FM38SVITCF</b>	420	367

$$\frac{\text{PN (bar)}}{10} = \text{PN (MPa)}$$