

See Customer Specification				
Code	Pos	Part	Description	Remarks / Items
C, C140	50	398000K008	Spool actuator C, C140	4(2x), 7, 8, 9
C; TPOL, SI	50; 52	6760041	Spring pack STD, centering force 80 N	6
C140	50	6760042	Spring pack C140, centering force 140 N	29
C + A020	50 + 59	398000K484	Spring pack, C+A020	6' (Valid also for TPOL/SI in pos. 52)
C140 + A020	50 + 59	6760470	Spring pack, C140+A020	29' (Valid also for TPOL/SI in pos. 52)
B2C	50	398000K059	Spool actuator B2C	4(2x), 9, 14, 15, 16 [5]
B2C	50	398000K159	Cap kit, B2C	4(2x), 9, 14, 15
B2C	50	398000K259	Spring/detent pack B2C	16 [5]
CB	50	398000K060	Spool actuator CB	4(2x), 9, 13 [5], 14, 17
CB	50	398000K160	Cap kit, CB	4(2x), 9, 14, 17
CB	50	398000K260	Spring/detent pack CB	13 [5]
C,C140,B2C,CB	50	398000K805	Seal kit C, C140, B2C, CB	3, 9(2x), 11 (See page 10)
TPOL	52	398000K420	Cap kit, TPOL	4(2x), 8, 9, 26
TPOL	52	6760044	Cylinder assembly, TPOL	27
C + SI	50 + 52	398000K204	Spool actuator C, position sensor	6, 8, 9, 24, 25(2x)
C + SI	50 + 52	398000K860	Position sensor SSP1 for C spool actuator	24
C + SI	50 + 52	6760819	Conversion kit spool actuator C with position sensor SSP2 from P70CF gen. 2	Not shown (For 1 sect. valve)
C + SI	50 + 52	6760765		Not shown (For 4 sect. valve)
C, C140; TPOL, SI	50; 52	6760544	Suport washer multipack	8(100x)

Open spool end: **C, C140, B2C, CB, SI, TPOL**

- ***
 Assembly instructions B2C and CB
1. Fasten the spool, or fix it against rotation
 2. Assemble O-ring (9), and Support ring (14) on spool
 3. Install Detent assy (13 or 16) into spool, use Allen key, tighten correctly
 4. Pull out Split pin (5) from the Detent assembly
 5. Assemble spool into the valve section
 6. Fasten Cap (15 or 25) with Screws (4)
 7. Tighten Screws

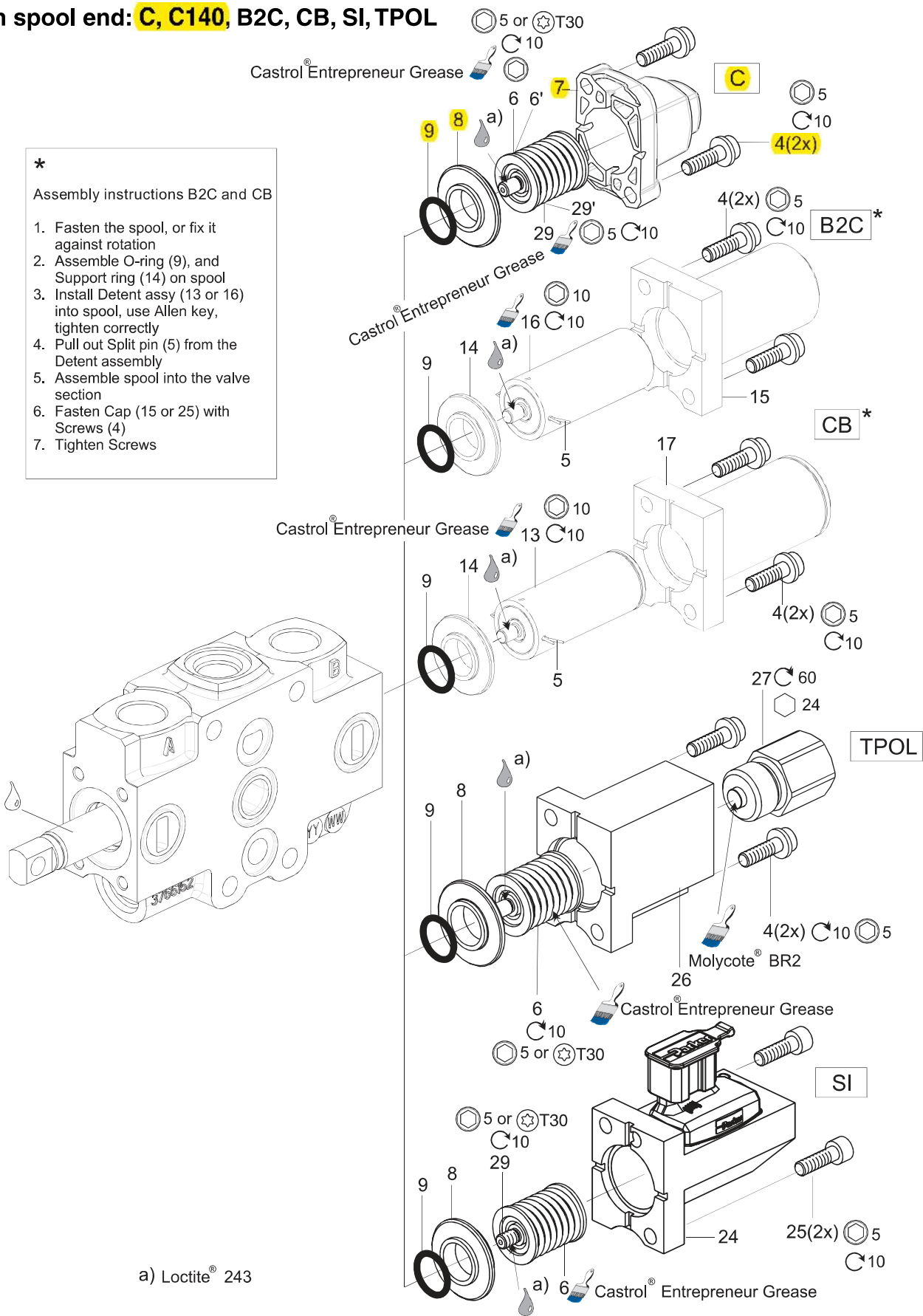

a) Loctite® 243