

# Pump Type P / V / X / S

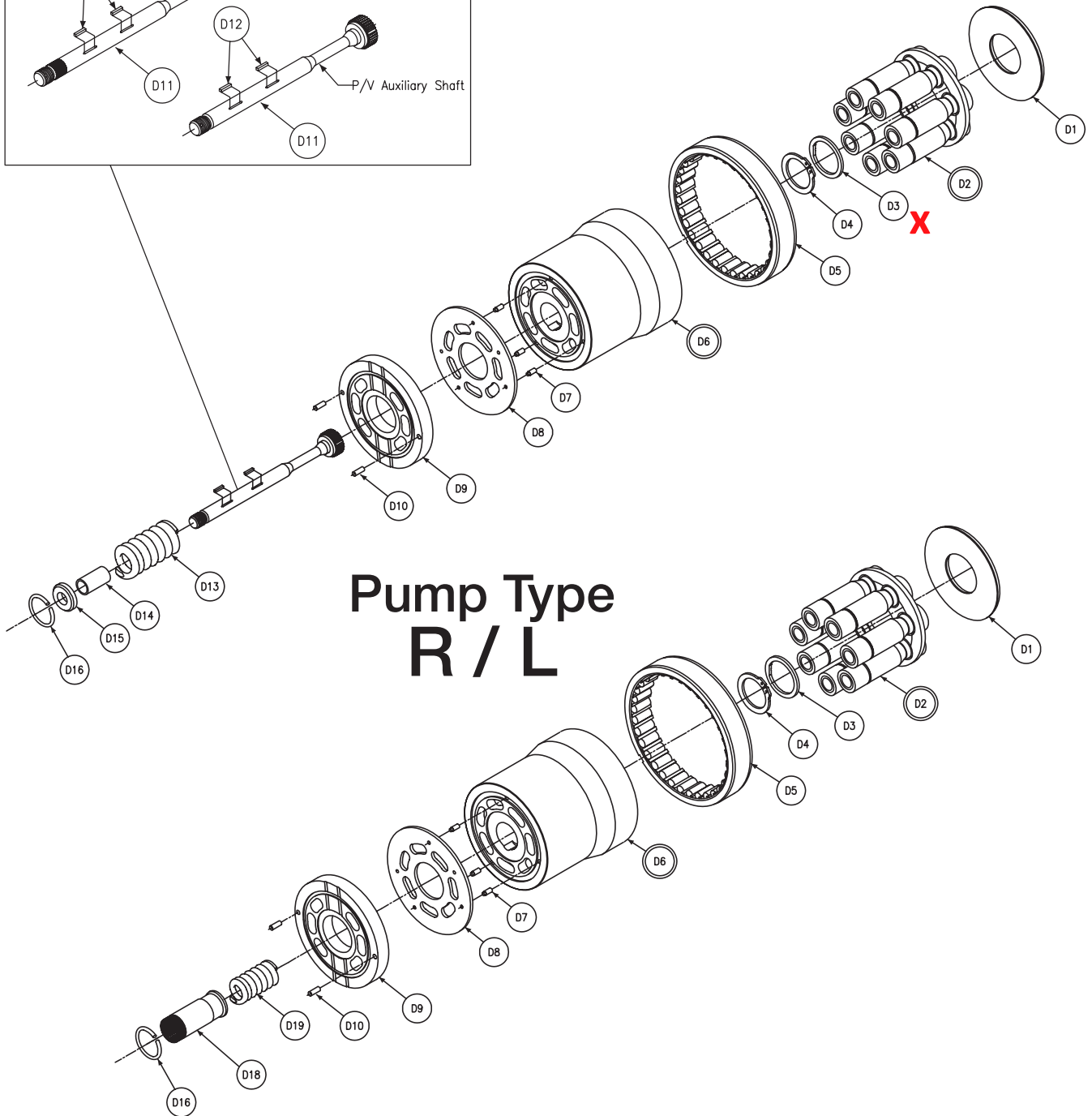
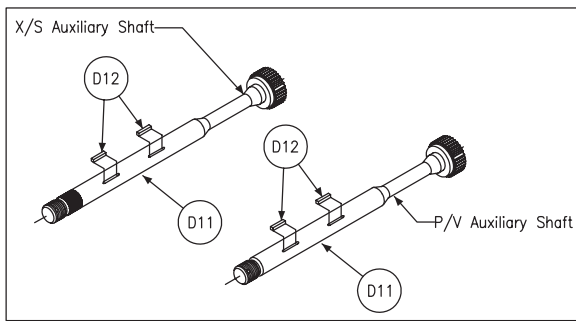

Section View - D - Rotating Group Assembly

| Section D             |              |           |          |             |   |     |
|-----------------------|--------------|-----------|----------|-------------|---|-----|
| P11/14 Rotating group |              |           |          |             |   |     |
| Balloon #             | Displacement | Pump Type | Rotation | Item #      | Description                             | Qty |
| D1                    | **           | **        | **       | 033-71569-0 | Creep plate                             | 1   |
| D2                    | P11          | **        | **       | S13-45544-0 | Piston and Shoes<br>w/Retainer Assembly | 1   |
|                       | P14          | **        | **       | S13-43970-0 |   |     |
| D3                    | **           | **        | **       | 033-91706-0 | Bearing, thrust                         | 1   |
| D4                    | **           | **        | **       | 033-71556-0 | Retaining Ring, Yellow, .109/.107 thk   | 1   |
|                       | **           | **        | **       | 035-71557-0 | Retaining Ring, Green, .107/.105 thk    |     |
|                       | **           | **        | **       | 035-71558-0 | Retaining Ring, Red, .105/.103 thk      |     |
|                       | **           | **        | **       | 035-71559-0 | Retaining Ring, Blue, .103/.101 thk     |     |
|                       | **           | **        | **       | 033-91231-0 | Retaining Ring, White, .100/.098 thk    |     |
| D5                    | **           | **        | **       | 033-91190-0 | Barrel Bearing                          | 1   |
| D6                    | P11          | **        | **       | S13-45381-0 | Barrel Assembly                         | 1   |
|                       | P14          | **        | **       | S13-43965-0 |   |     |
| D7                    | **           | **        | **       | 033-49825-0 | Pin, Face & Port Plate                  | 3   |
| D8                    | P11          | **        | **       | 033-71921-0 | Face plate                              | 1   |
|                       | P14          | **        | **       | 033-71575-0 |   |     |
| D9                    | P11          | P/S/X/R/L | CW       | 033-71915-0 | Port Plate                              | 1   |
|                       | P11          | P/S/X/R/L | CCW      | 033-71914-0 |   |     |
|                       | P14          | P/S/X/R/L | CW       | 033-71617-0 |   |     |
|                       | P14          | P/S/X/R/L | CCW      | 033-71600-0 |   |     |
|                       | P11          | V         | CW       | 033-91195-0 |   |     |
|                       | P11          | V         | CCW      | 033-91224-0 |   |     |
|                       | P14          | V         | CW       | 033-91241-0 |   |     |
|                       | P14          | V         | CCW      | 033-91242-0 |   |     |
| D10                   | **           | **        | **       | 324-21610-0 | Dowel Pin                               | 2   |
| D11                   | **           | P/V       | **       | 033-71603-0 | Shaft, Auxiliary Drive                  | 1   |
|                       | **           | S/X       | **       | 033-91053-0 |   |     |
| D12                   | **           | V         | **       | 211-22034-0 | Square Key                              | 1   |
|                       | **           | P/S/N/X   | **       |             |   | 2   |
| D13                   | **           | P/S/N/X   | **       | 033-71562-0 | Holddown Spring                         | 1   |
| D14                   | **           | P/S/N/X   | **       | 033-71561-0 | Barrel Stop                             | 1   |
| D15                   | **           | P/S/N/X   | **       | 033-71560-0 | Spring Retainer                         | 1   |
| D16                   | **           | **        | **       | 033-71564-0 | Retaining Ring                          | 1   |
| D18                   | **           | R/L       | **       | 033-92687-0 | Holddown Sleeve                         | 1   |
| D19                   | **           | R/L       | **       | 033-92686-0 | Holddown Spring                         | 1   |

| Major Rotating Group           |            |          |             |
|--------------------------------|------------|----------|-------------|
| Composed of Items:             |            |          |             |
| D1,D2,D5,D6,D7, D8, D9,and D10 |            |          |             |
| Displacement                   | Model Type | Rotation | Part Number |
| P11                            | P/X/S/R/L  | CW       | S23-17101-0 |
| P11                            | P/X/S/R/L  | CCW      | S23-17102-0 |
| P11                            | V          | CW       | S23-17105-0 |
| P11                            | V          | CCW      | S23-17106-0 |
| P14                            | P/X/S/R/L  | CW       | S23-17103-0 |
| P14                            | P/X/S/R/L  | CCW      | S23-17104-0 |
| P14                            | V          | CW       | S23-17107-0 |
| P14                            | V          | CCW      | S23-17108-0 |

| Barrel Hold Down                    |            |          |             |
|-------------------------------------|------------|----------|-------------|
| Composed of Items:                  |            |          |             |
| D11,D13,D14,D15 and D16 For P/V/X/S |            |          |             |
| No Kit available for R/L versions   |            |          |             |
| Displacement                        | Model Type | Rotation | Part Number |
| P11/14                              | P/V        | **       | S23-17250-0 |
| P11/14                              | X/S        | **       | S23-17251-0 |

