

FITS CAVITY 3G  
 MAXIMUM WORKING PRESSURE 210 BAR  
 ALL EXTERNAL STEEL PARTS ZINC PLATED.  
 PRIORITY FLOW – 6 L/MIN.  
 SWITCHABLE TO – 18 L/MIN  
 COIL VOLTAGE – 24 VDC.

TIGHTEN ITEM 1 INTO  
 ITEM 3 WITH A TORQUE  
 OF 20Nm.

SUPPLY ITEM 2 LOOSE.

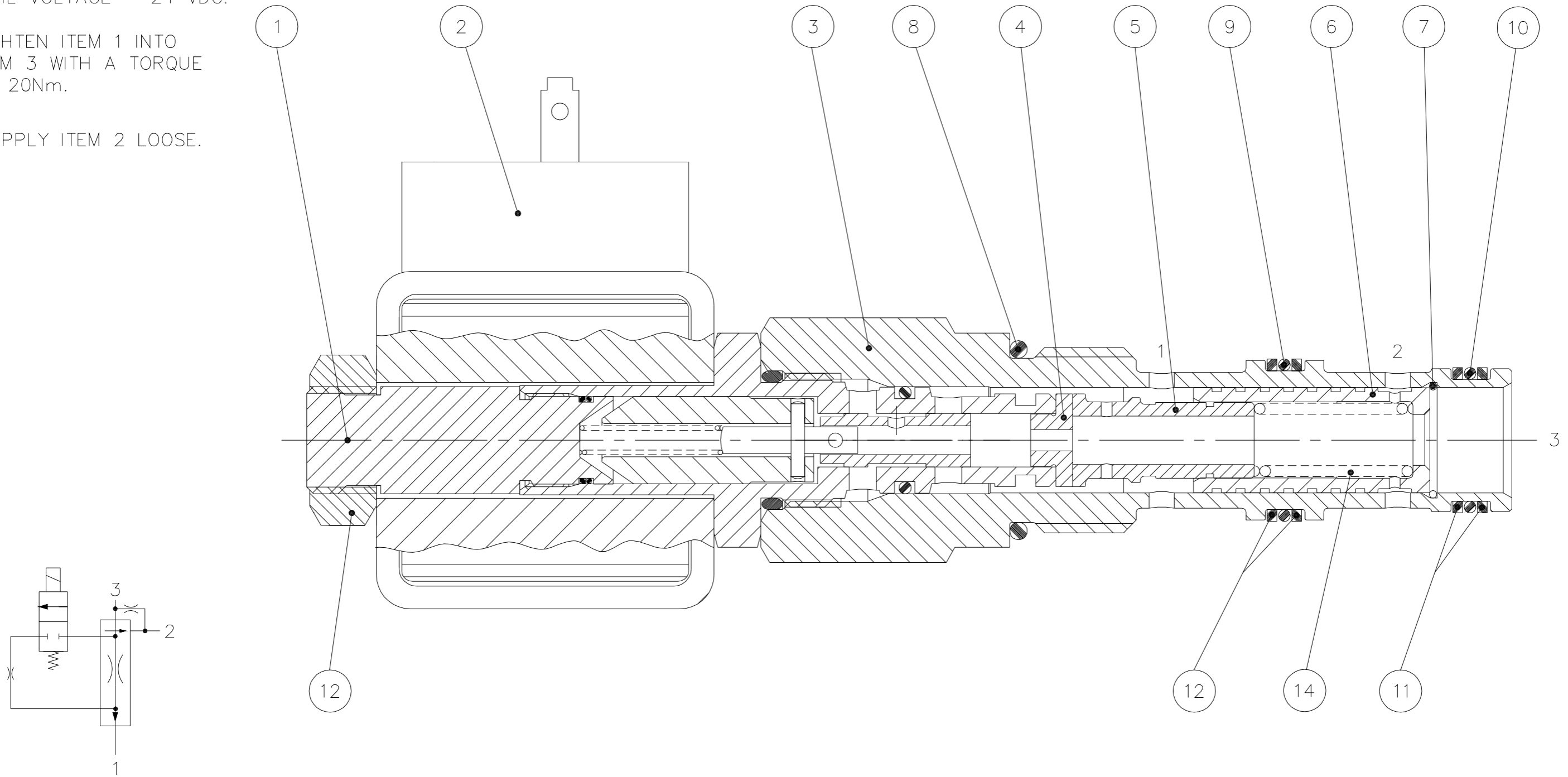

USED ON EX 4037	THIS DRAWING IS CONFIDENTIAL AND SUPPLIED BY STERLING HYDRAULICS. IT IS NOT TO BE COMMUNICATED OR COPIED TO ANY OTHER PERSON WITHOUT THE WRITTEN CONSENT OF STERLING HYDRAULICS LTD		MATERIAL	UNLESS STATED REMOVE SHARP EDGES BY LINEAR TOL ± ANGULAR TOL ± SURFACE FINISH $\mu\text{m Ra}$ ALL DIAMETERS ON A COMMON AXIS TO HAVE A MAX TOTAL RUNOUT OF SQUARE FEATURES TO BE WITHIN MAX	BS.308 DO NOT SCALE		B	MOD M.2251	C.GREASY 08/06/00
			FINISH/TREATMENT				A	DRAWN	H.JOHNSON 20/04/00
DRAWN H.JOHNSON 20/04/00	CHECKED G.J.FRY 25/04/00	PROD'N APPROVED		SCALE 2:1	ALL DIMENSIONS IN mm		ISSUE	REVISION	DRN/DATE
TITLE GENERAL ASSY. J1A060 SPECIAL 6 & 18 l/min. WITH 40L/MIN INLET FLOW.							CAD PROCEDURES APPLY TO THIS DRAWING		
							DIVISION VALVE		
							DRG NO ASV015756		