

PUMP DATA	
DISPLACEMENT	16,0 ccm
MAX. CONT. PRESSURE	275 bar
SPEED RATE	500 TO 3000 min ⁻¹
MAX. INPUT SHAFT TORQUE	193 NM
ROTATION	ANTI CLOCKWISE

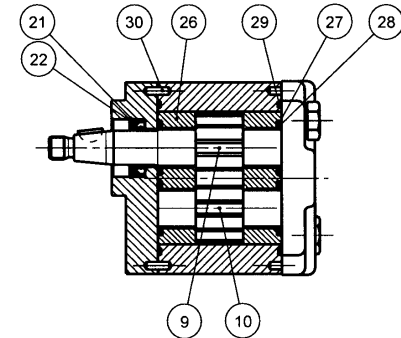
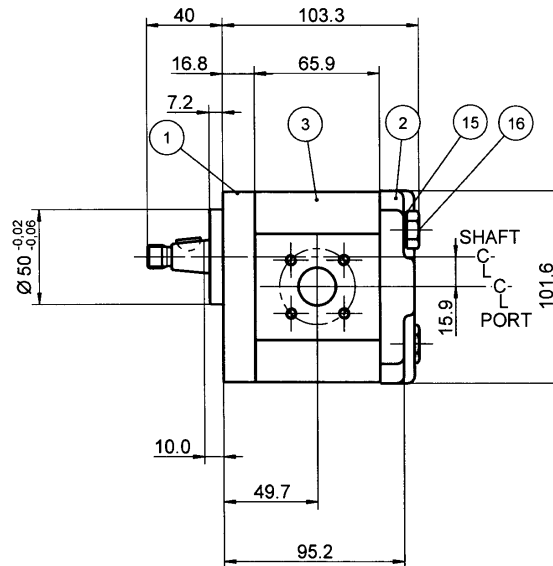
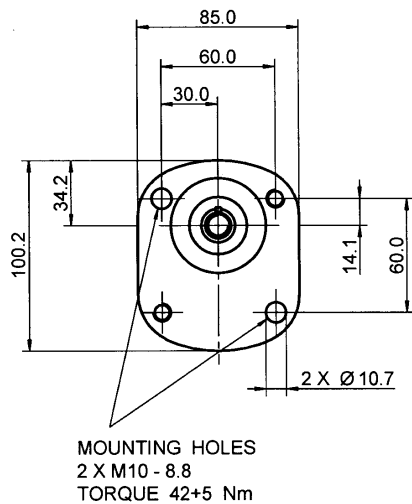
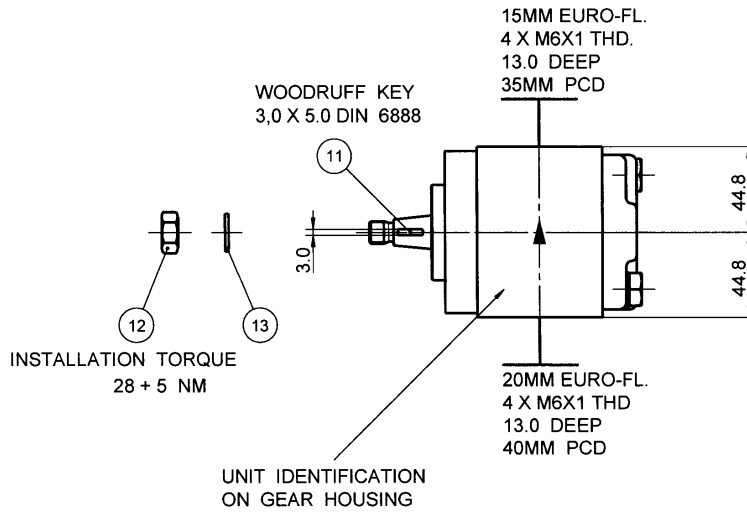
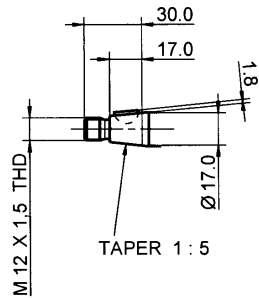

NOTE

1 FOR ASSEMBLY INSTRUCTIONS SEE DWG. NO. "511-B1" "PGP511 PUMP ASSEMBLY INSTRUCTIONS".

ITEM	PART NO	REQD	ITEM	PART NO	REQD
28	8611-015-000	2	SEAL. BK-UP	36	
27	8611-016-00R	2	SEAL. CHAN.	35	
26	8898-207-00U	2	THRBLK/BSHG	34	
25				33	
24				32	
23				31	
22	9211-323-00B	1	RING, SNAP	30	391 2080 078 2
21	8301-019-00K	1	SEAL. LIP	29	9313-145-00B 2

ITEM	PART NO	REQD	DESCRIPTION
20			
19			
18			
17			
16	391 1401 544	2	SCREW (95 MM)
15	391 3782 231	2	WASHER
14			
13	391 3782 259	1	WASHER
12	391 1451 160	1	NUT
11	391 1781 099	1	KEY
10	334 2716 000	1	DRIVEN GEAR
9	334 1816 600	1	DRIVE GEAR
8			
7			
6			
5			
4			
3	334 8116 901	1	HOUSING. GEAR
2	332 3000 100	1	HOUSING. PEC
1	334 5051 202	1	HOUSING. SEC

THIRD ANGLE PROJECTION
EXP. NO.
FIRST USED
02 - 04 - 99921
334 9112 276

SYM.	REVISIONS

THIS DOCUMENT CONTAINS INFORMATION THAT IS CONFIDENTIAL AND PROPRIETARY TO PARKER HANNIFIN CORPORATION ("PARKER"). THIS DOCUMENT IS FURNISHED ON THE UNDERSTANDING THAT THE DOCUMENT AND INFORMATION WILL BE NOT COPIED OR DISCLOSED TO OTHERS OR USED FOR ANY PURPOSE OTHER THAN CONDUCTING BUSINESS WITH PARKER, AND WILL BE RETURNED AND ALL FURTHER USE DISCONTINUED UPON REQUEST BY PARKER. ALL RIGHTS RESERVED.

Parker Hydraulic Controls Division
Sachsenhydraulik GmbH Chemnitz

PGP511A0160AS1Q4NJ7J5B1B1

MATERIAL	ADM CTR P	DR BY DATE PG 14MAY02	CH BY DATE WS 14MAY02	SCALE 1/2
H.E.-STD:	REV DTE 000000	334 9112 276		
WT 3.9 Kg	DIMENSIONS ARE MM		© 2002 Parker-Hannifin Corporation	