

**Dimensions**

**Proportional Directional Control Valves  
Series D\*1FB\*EE with Atex Coils**

Inch equivalents for millimeter dimensions are shown in (\*\*)



**D31FB\*EE**

**A**

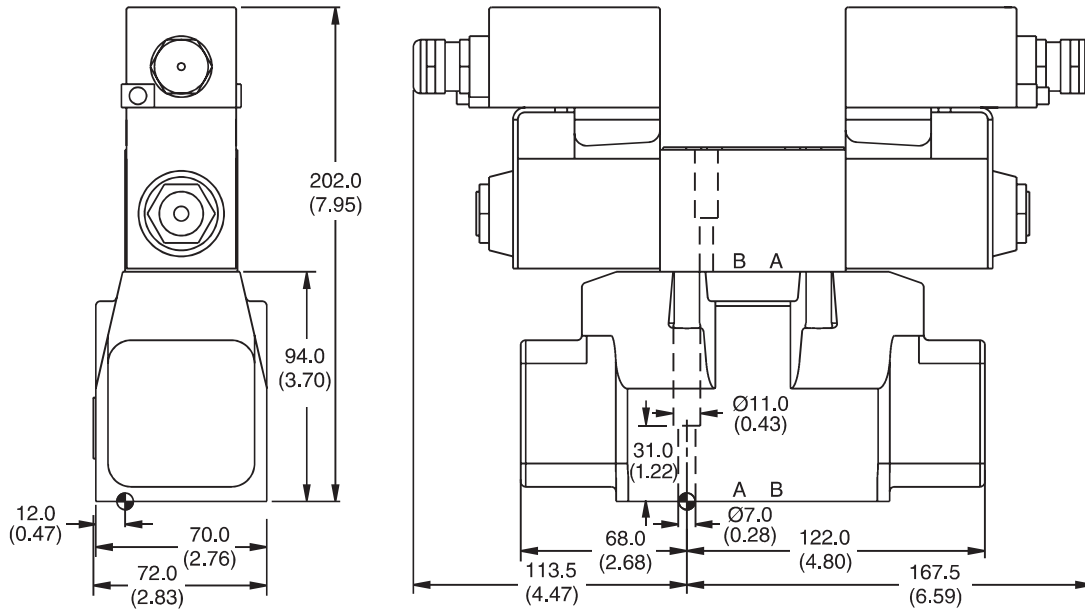

Surface Finish	Kit	Wrench	Wrench	Seal Kit
	BK385 BK98	4x M6x40 DIN 912 12.9 4x 1/4-20x1.62	13.2 Nm (9.7 lb.-ft.) ±15 %	Nitrile: SK-D31FB Fluorocarbon: SK-D31FBV

**D41FB\*EE**

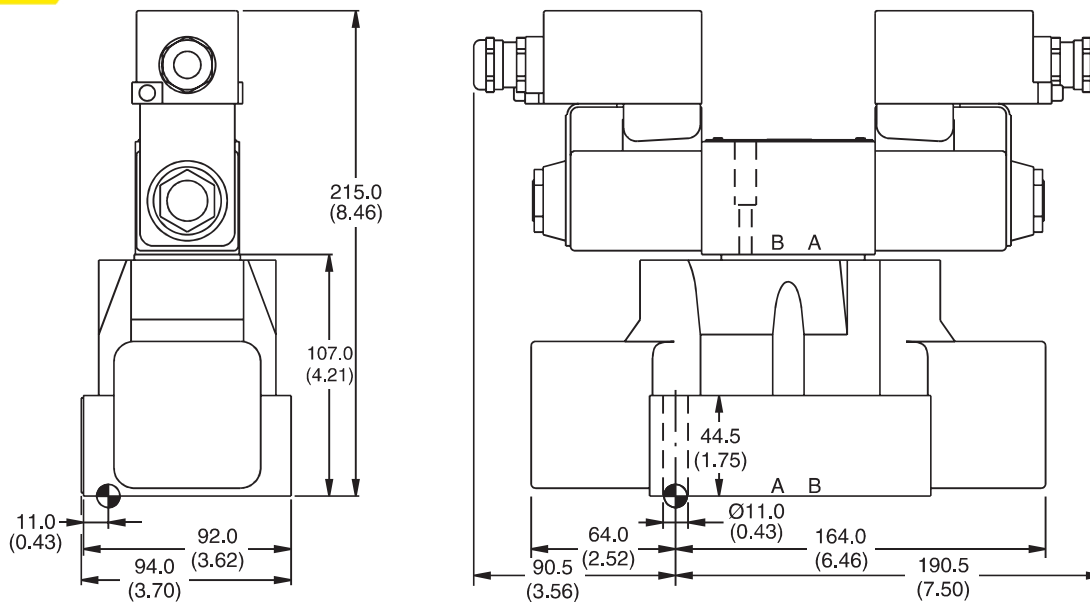

Surface Finish	Kit	Wrench	Wrench	Seal Kit
	BK320 BK160	2x M6x55 4x M10x60 DIN 912 12.9 4x 3/8-16x2.5 4X 3/8-16X2.5	13.2 Nm (9.7 lb.-ft.) 63 Nm (46.5 lb.-ft.) ±15 %	Nitrile: <b>SK-D41FB</b> Fluorocarbon: SK-D41FBV

D\_1FB\_EE.indd, ddp

