

Check Valve, Ball Type

SC1F-A2

3/4-16 UNF • Q_{max} 40 l/min (11 GPM) • p_{max} 420 bar (6100 PSI)

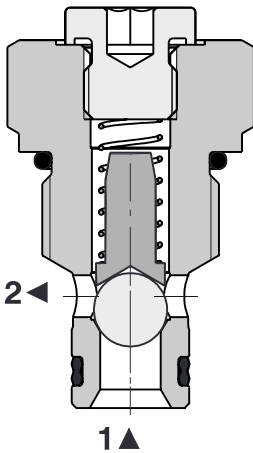

Technical Features

- > Hardened precision parts
- > Sharp-edged steel seats for dirt-tolerant performance
- > Leak-free closing, suitable for fast cycling with long life
- > High flow capacity
- > Optional bias spring ranges for back-pressure control
- > In the standard version, the valve is zinc-coated for 520 h protection acc. to ISO 9227

Functional Description

A hydraulic check valve in the form of a screw-in cartridge-style for use as a blocking or load-holding device. The cartridge has a ball check which is closed by spring until sufficient pressure is applied at port 1 to open flow to port 2.



Technical Data

Valve size / Cartridge cavity		3/4-16 UNF-2A / A2			
Max. flow	l/min (GPM)	40 (10.6)			
Max. operating pressure	bar (PSI)	420 (6090)			
Cracking pressure	bar	0.5	1.5	3.5	7.0
	(PSI)	(7.3)	(21.8)	(50.8)	(101.5)
Fluid temperature range (NBR)	°C (°F)	-30 +100 (-22 ... +212)			
Fluid temperature range (FPM)	°C (°F)	-20 +120 (-4 ... +248)			
Weight	kg (lbs)	0.08 (0.18)			

		Datasheet	Type
General information		GI_0060	Products and operating conditions
Valve bodies	In-line mounted	SB_0018	SB-A2*
	Sandwich mounted	SB-04(06)_0028	SB-*A2*
Cavity details / Form tools		SMT_0019	SMT-A2*
Spare parts		SP_8010	

Characteristics measured at $v = 32 \text{ mm}^2/\text{s}$ (156 SUS)

Pressure drop related to flow rate

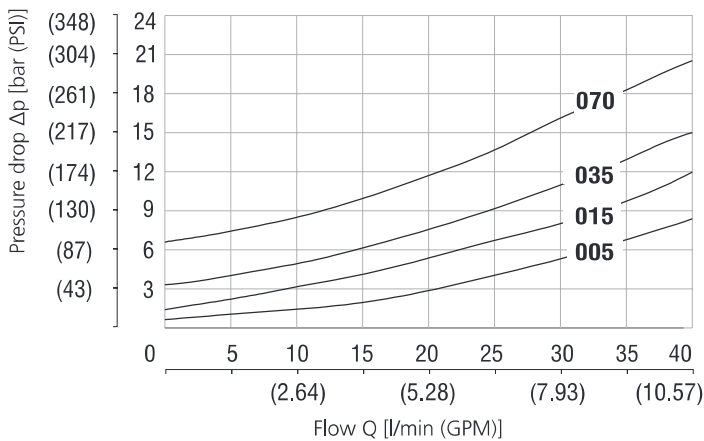

Dimensions in millimeters (inches)

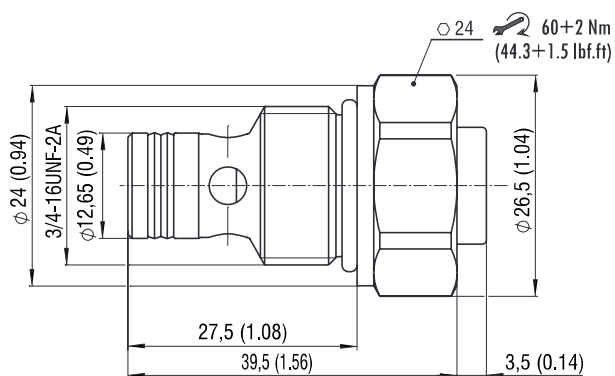

Ordering Code

