

Ordering Code: **ML-2A3-X-Y 01-Z**

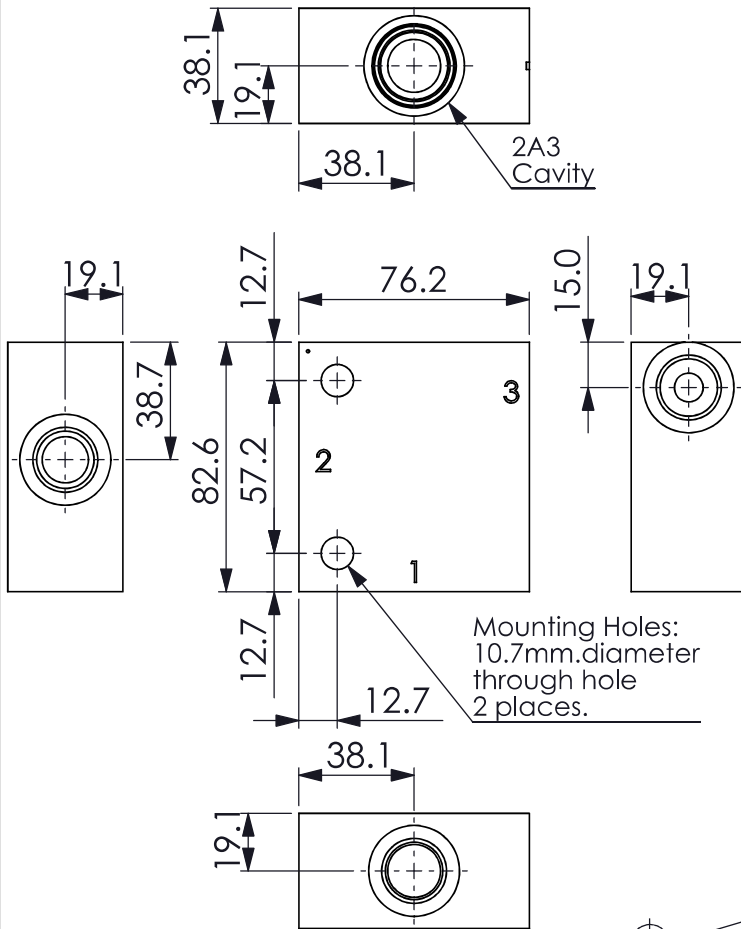

UNIT:mm

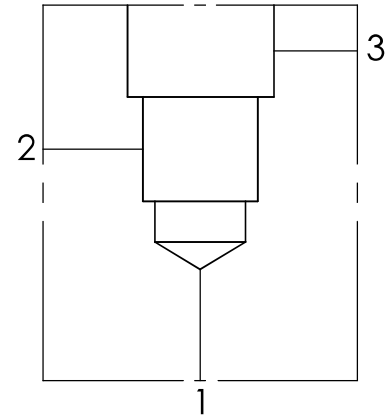

TECHNICAL DATA

Aluminum Body Pressure Rating: 210 bar

Ductile Iron Body Pressure Rating: 350 bar

Cavity:

Refer to 2A3

* Refer to Winner Cartridge Valves Catalog.

Aluminum	0.53 kg(WITHOUT VALVES)
----------	-------------------------

Ductile Iron	1.4 kg(WITHOUT VALVES)
--------------	------------------------

* If you need the special specification.
Please contact us.

PORT SIZE

X	PORTS	PORT	
	1,2	3	
G04A	G 1/2"	G 1/4"	
G06A	G 3/4"	G 1/4"	
S08A	SAE 8	SAE 6	
S10A	SAE 10	SAE 6	
S12A	SAE 12	SAE 6	

Y

BODY MATERIAL

A

HIGH-STRENGTH ALUMINUM

S

DUCTILE IRON

Z

CARTRIDGE VALVES SELECTION

WITHOUT VALVE

RV3A RV2A30AL (120LPM,7-210bar)

CB3H CB2A33HL (3:1 , 7-280bar)

CO03 CO2A3003N (120LPM ,0.3bar)

The selection is only example. Please refer to Winner Cartridge Program and to select the appropriate valves and manifolds assembly in accordance with request function (flow 、 pressure 、 ... etc.)