

MESSING-KUPPLUNGEN

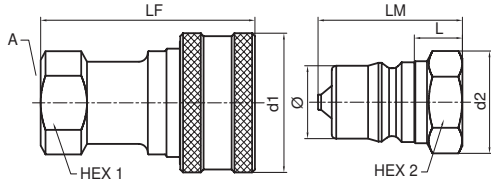

Baugröße Zoll	Gewinde A Zoll	d1 mm	Hex 1	LF mm	d2 mm	Hex 2	L mm	LM mm	Ø mm	Bestellnummer Muffe	Gewicht gr./Stück	Bestellnummer Stecker	Gewicht gr./Stück
BSPP Innengewinde													
1/8"	1/8	24.4	14 mm	48.3	16.1	14 mm	10.5	32.5	10.8	BH1-60-BSPP	87	BH1-61-BSPP	19
1/4"	1/4	29.0	19 mm	61.2	21.9	19 mm	16.6	39.1	14.2	BH2-60-BSPP	158	BH2-61-BSPP	45
3/8"	3/8	35.6	1"	69.9	25.7	7/8"	19.7	44.7	19.1	BH3-60-BSPP	260	BH3-61-BSPP	74
1/2"	1/2	45.0	1 1/8"	77.5	33.0	1 1/8"	21.1	49.3	23.5	BH4-60-BSPP	383	BH4-61-BSPP	131
3/4"	3/4	54.4	33 mm	90.4	40.3	1 3/8"	21.9	57.7	31.4	BH6-60-BSPP	642	BH6-61-BSPP	235
1"	1	64.0	41 mm	106.2	47.2	41 mm	25.2	73.8	37.7	BH8-60-BSPP	971	BH8-61-BSPP	368

NPTF Innengewinde													
1/8"	1/8-27	24.4	11/16"	48.3	16.4	9/16"	10.5	29.5	10.8	BH1-60	80	BH1-61	19
1/4"	1/4-18	29.0	13/16"	57.4	22.1	4/3"	12.7	35.3	14.2	BH2-60	145	BH2-61	46
3/8"	3/8-18	35.6	7/8"	63.2	25.7	7/8"	13.1	38.1	19.1	BH3-60	195	BH3-61	62
1/2"	1/2-14	45.0	1 1/8"	72.9	33.0	1 1/8"	16.4	44.5	23.5	BH4-60	365	BH4-61	118
3/4"	3/4-14	54.4	1 5/16"	90.4	40.4	1 3/8"	19.1	54.9	31.4	BH6-60	630	BH6-61	229
1"	1-11 1/2	64.0	1 5/8"	106.2	47.8	1 5/8"	25.2	65.5	37.7	BH8-60	980	BH8-61	378

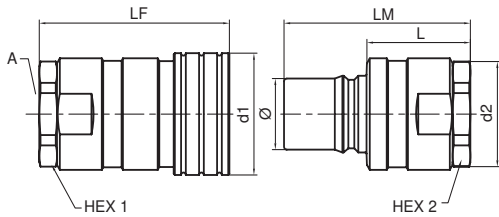

Baugröße Zoll	Gewinde A Zoll	d1 mm	Hex 1 Zoll	LF mm	d2 mm	Hex 2 Zoll	L mm	LM mm	Ø mm	Bestellnummer Muffe	Bestellnummer Stecker
BSPP Innengewinde											
1 1/2"	1 1/4	76.2	2 3/8"	123.4	75.1	2 3/8"	67.5	120.9	44.5	BH12-60L-BSPP	BH12-61L-BSPP
	1 1/2	76.2	2 3/8"	127.3	75.1	2 3/8"	67.5	124.7	44.5	BH12-60N-BSPP	BH12-61N-BSPP
2 1/2"	2	101.1	3 3/4"	145.0	104.1	3 3/4"	77.3	142.7	63.2	BH2016-60-BSPP	BH2016-61-BSPP
	2 1/2	101.1	3 3/4"	170.2	104.1	3 3/4"	102.3	167.9	63.2	BH2020-60-BSPP	BH2020-61-BSPP
	3	101.1	4"	180.3	104.1	4"	112.7	178.0	63.2	BH2024-60-BSPP	BH2024-61-BSPP
NPTF Innengewinde											
1 1/2"	1 1/4-11 1/2	76.2	2 3/8"	123.4	75.1	2 3/8"	67.3	120.9	44.5	BH12-60L	BH12-61L
	1 1/2-11 1/2	76.2	2 3/8"	123.4	75.1	2 3/8"	67.3	120.9	44.5	BH12-60N	BH12-61N
2 1/2"	2-11 1/2	101.1	3 3/4"	141.5	104.1	3 3/4"	73.7	139.2	63.2	BH2016-60	BH2016-61
	2 1/2-8	101.1	3 3/4"	153.4	104.1	3 3/4"	85.6	151.1	63.2	BH2020-60	BH2020-61
	3-8	101.1	4"	176.8	104.1	4"	109.0	174.5	63.2	BH2024-60	BH2024-61

Bemerkung: Kupplungen mit UNF-Gewinde sind auf Anfrage verfügbar. Für weitere Informationen wenden Sie sich bitte an die nächste Parker-Niederlassung.