

**Vane-Type Motor**  
Series M1C - M1C1

**Flügelzellen-Motor**  
Baureihe M1C - M1C1

**Moteur à Palettes**  
Série M1C - M1C1

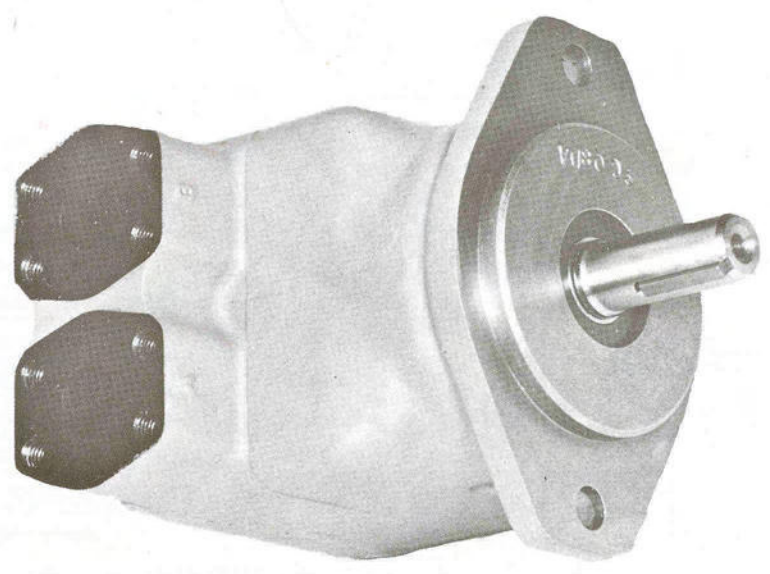
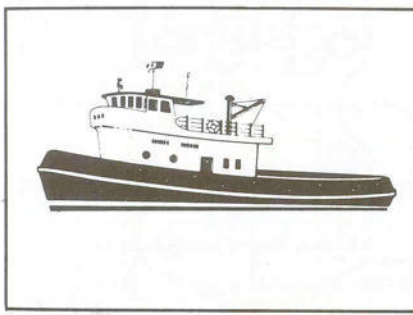
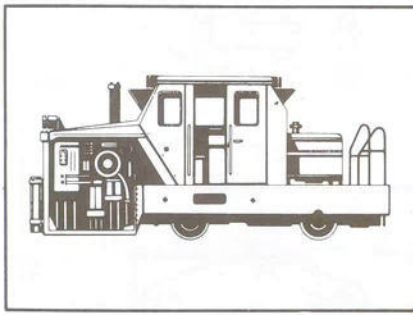
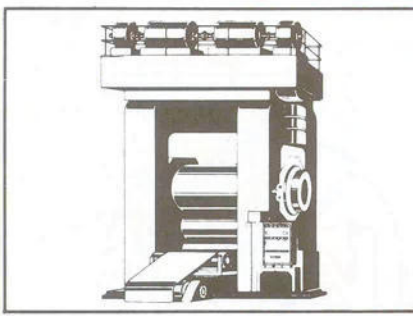
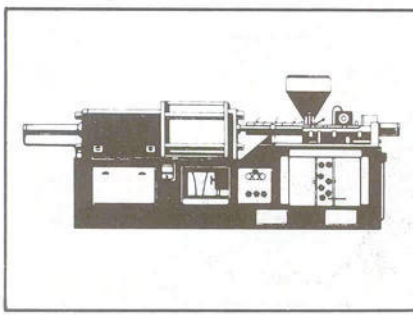

Recommended repair kits and assy's are bolt printed  
 Empfohlene Austausch - Baugruppen sind fett gedruckt  
 Les pochettes de rechanges recommandées sont imprimées en caractères gras

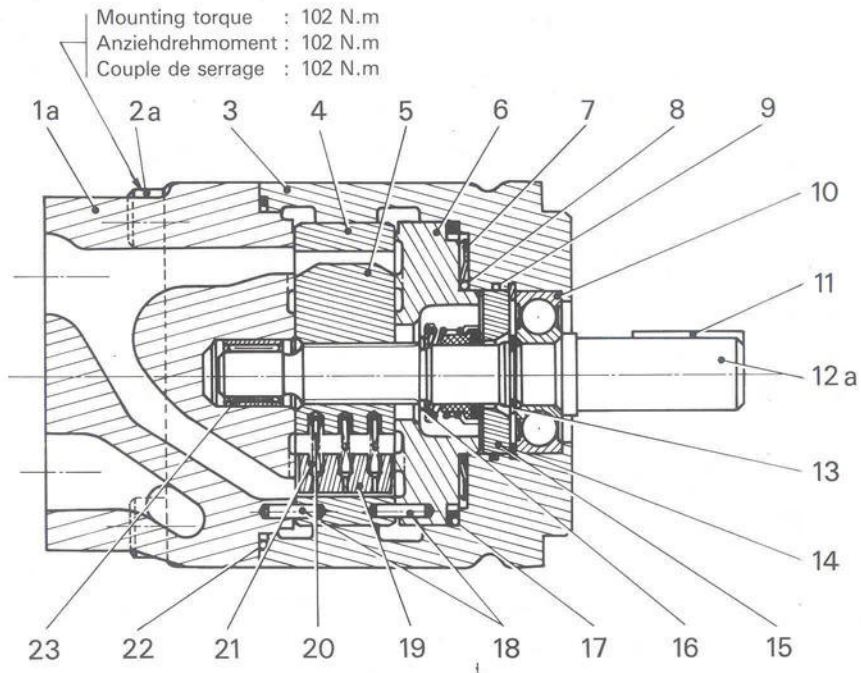

Mounting torque : 110 N.m  
 Anziehdrehmoment : 110 N.m  
 Couple de serrage : 110 N.m

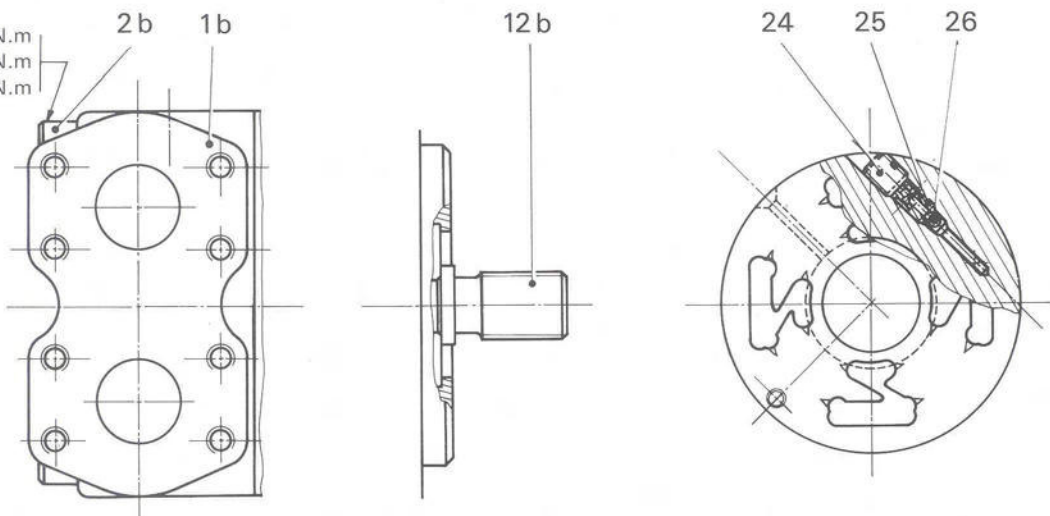

Detail M1C1 rear and side porting - Detail M1C1 axiale und seitliche Anschlüsse - Détail M1C1 orifices arrière et de côtés.

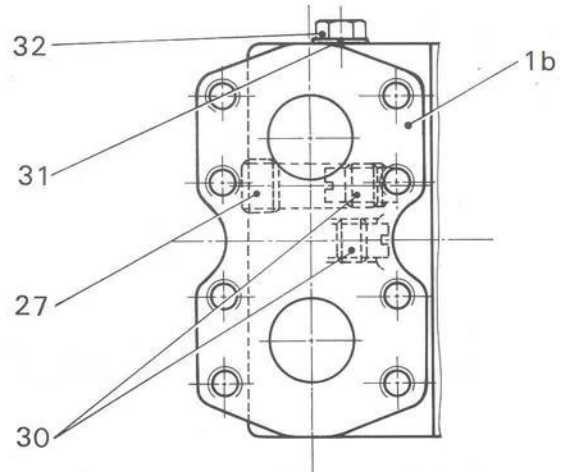
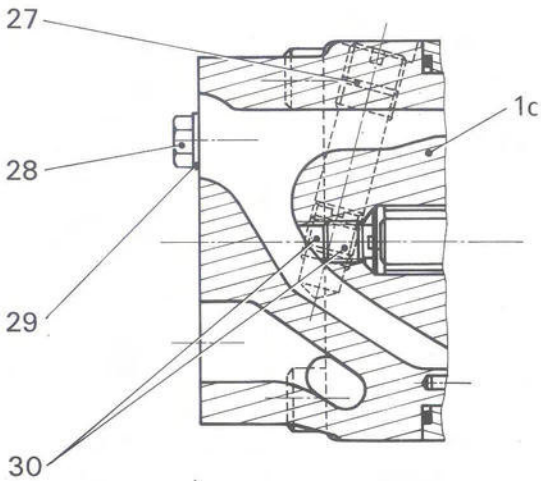



| Item Pos. Réf. | Description                           | Benennung                                   | Description                          |   | Part N°<br>Teil Nr<br>Code N° | Qty.<br>Stück<br>Qté |
|----------------|---------------------------------------|---|--------------------------------------|---|-------------------------------|----------------------|
| 1a             | End cap rear ported (M1C)             | Deckel (axiale Anschlüsse) (M1C)            | Chapeau orifices ar. (M1C)           | ⊖ | 034-32062                     | 1                    |
| 1c             | End cap rear ported (M1C1)            | Deckel (axiale Anschlüsse)(M1C1)            | Chapeau orifices ar. (M1C1)          | ⊖ | 034-66211                     | 1                    |
| 1b             | End cap side ported (M1C)             | Deckel (seitliche Anschlüsse) (M1C)         | Chapeau orifices côté (M1C)          | ⊖ | 034-66072                     | 1                    |
| 1d             | End cap side ported (M1C1)            | Deckel (seitliche Anschlüsse) (M1C1)        | Chapeau orifices côté (M1C1)         | ⊖ | 034-66274                     | 1                    |
| 2a             | Screw (rear ported)                   | Schraube (für axiale Anschlüsse)            | Vis (orifices ar.)                   |   | 358-20240                     | 4                    |
| 2b             | Screw (side ported)                   | Schraube (für seitliche Anschlüsse)         | Vis (orifices de côté)               |   | 358-20320                     | 4                    |
| 3              | Housing                               | Pumpengehäuse                               | Carter                               |   | 034-40950                     | 1                    |
| 4              | Cam ring 024                          | Hubring 024                                 | Came 024                             | × | 034-40955                     | 1                    |
|                | Cam ring 033                          | Hubring 033                                 | Came 033                             | × | 034-40954                     | 1                    |
|                | Cam ring 042                          | Hubring 042                                 | Came 042                             | × | 034-40953                     | 1                    |
|                | Cam ring 052                          | Hubring 052                                 | Came 052                             | × | 034-40952                     | 1                    |
| 5              | Rotor                                 | Rotor                                       | Rotor                                | × | 034-27256                     | 1                    |
| 6              | Port plate-pressure                   | Steuerplatte                                | Plaque pression                      | + | 034-66309                     | 1                    |
| 7              | Washer spring                         | Tellerfeder                                 | Rondelle ressort                     |   | 350-10019                     | 1                    |
| 8              | Sq. section seal                      | Dichtring                                   | Joint section carrée                 | ■ | 691-10137                     | 1                    |
| 9              | Seal                                  | Dichtring                                   | Joint                                | ■ | 034-66467                     | 1                    |
| 10             | Ball bearing                          | Kugellager                                  | Roulement à billes                   | ● | 230-82044                     | 1                    |
| 11             | Key                                   | Paßfeder                                    | Clavette                             | ▲ | 034-49622                     | 1                    |
| 12a            | Shaft (keyed) (code 1)                | Welle für Paßfeder (Typ 1)                  | Arbre à clavette (code 1)            | ▲ | 034-40997                     | 1                    |
| 12b            | Shaft (splined) (code 3)              | Vielkeilwelle (Typ 3)                       | Arbre à cannelures (code 3)          | ● | 034-40998                     | 1                    |
| 13             | Retaining ring                        | Sicherungsring                              | Circlips                             | ▲ | 356-31078                     | 1                    |
| 14             | Retaining ring                        | sicherungsring                              | Circlips                             | ● | 356-30206                     | 1                    |
| 15             | Shaft seal                            | Simmerring                                  | Joint d'arbre                        | ▲ | 623-12559                     | 1                    |
| 16             | Retaining ring                        | Sicherungsring                              | Circlips                             | ▲ | 356-31075                     | 1                    |
| 17             | Sq. section seal                      | Dichtring                                   | Joint section carrée                 | ■ | 691-10238                     | 1                    |
| 18             | Dowel pin                             | Zentrierstift                               | Goupille                             |   | 324-21210                     | 2                    |
| 19             | Vane                                  | Flügel                                      | Palette                              | × | 034-24851                     | 10                   |
| 20             | Spring guide                          | Federführung                                | Guide de ressort                     | × | 034-40687                     | 30                   |
| 21             | Vane spring                           | Feder für Flügel                            | Ressort de palette                   | × | 034-41676                     | 30                   |
| 22             | Sq. section seal                      | Dichtung                                    | Joint section carrée                 | ■ | 691-10242                     | 1                    |
| 23             | Needle bearing                        | Nadellager                                  | Roulement à aiguilles                | ⊖ | 230-82008                     | 1                    |
| 24             | Plug                                  | Stopfen                                     | Bouchon                              | + | 312-35056                     | 1                    |
| 25             | Adaptor valve                         | Kugelventil                                 | Adapteur valve                       | + | 034-53346                     | 1                    |
| 26             | Ball                                  | Kugel                                       | Bille d'acier                        | + | 201-06001                     | 1                    |
| 27             | Plug                                  | Stopfen                                     | Bouchon                              | ⊖ | 431-90600                     | 1                    |
| 28             | Plug                                  | Stopfen                                     | Bouchon                              | ⊖ | 446-01004-2                   | 1                    |
| 29             | Copper seal                           | Kupferdichtung                              | Bague cuivre                         | ⊖ | 612-00001-3                   | 1                    |
| 30             | Check valve                           | Rückschlagventil                            | Clapet                               | ⊖ | S14-01257                     | 2                    |
| 31             | Washer thread seal                    | Dichtring                                   | Bague BS                             | ⊖ | 635-01006-2                   | 1                    |
| 32             | Plug                                  | Stopfen                                     | Bouchon                              | ⊖ | 446-01006-2                   | 1                    |
|                | <b>REPAIR KIT</b>                     | <b>AUSTAUSCH-BAUGRUPPEN</b>                 | <b>POCHETTES RECHANGES</b>           |   |                               |                      |
| ×              | <b>Kit 024</b>                        | <b>Pumpeneinsatz 024</b>                    | <b>Cartouche 024</b>                 |   | S14-13612                     | 1                    |
| ×              | <b>Kit 033</b>                        | <b>Pumpeneinsatz 033</b>                    | <b>Cartouche 033</b>                 |   | S14-13613                     | 1                    |
| ×              | <b>Kit 042</b>                        | <b>Pumpeneinsatz 042</b>                    | <b>Cartouche 042</b>                 |   | S14-13614                     | 1                    |
| ×              | <b>Kit 052</b>                        | <b>Pumpeneinsatz 052</b>                    | <b>Cartouche 052</b>                 |   | S14-13615                     | 1                    |
| +              | <b>Kit port plate pressure ass'y</b>  | <b>Steuerplatte (Baugruppe)</b>             | <b>Plaque pression ass.</b>          |   | S14-13913                     | 1                    |
| ■              | <b>Seal Kit</b>                       | <b>Satz Dichtringe</b>                      | <b>Pochette de joints</b>            |   | S14-09944                     | 1                    |
| ⊖              | <b>End cap ass'y rear port. (M1C)</b> | <b>Deckel (Baugr.) axiale Anschl. (M1C)</b> | <b>Chapeau ass. orif. ar. (M1C)</b>  |   | S14-83314                     | 1                    |
| ⊖              | <b>End cap ass'y side port. (M1C)</b> | <b>Deckel (Baugr.) seitl. Anschl. (M1C)</b> | <b>Chapeau ass. orif. côté (M1C)</b> |   | S14-83315                     | 1                    |

| Item Pos. Réf. | Description                      | Benennung                              | Description                      | Part N°<br>Teil Nr<br>Code N° | Qty-<br>Stück<br>Qté |
|----------------|----------------------------------|--|----------------------------------|-------------------------------|----------------------|
| ☒              | End cap ass'y rear port. (M1C1)  | Deckel (Baugr.) axiale Anchl. (M1C1)   | Chapeau ass. orif. ar. (M1C1)    | S14-83886                     | 1                    |
| ☒              | End cap ass'y side port. (M1C1)  | Deckel (Baugr.) seitl. Anchl. (M1C1)   | Chapeau ass. orif. côté (M1C1)   | S14-93377                     | 1                    |
| ▲              | Shaft and key ass'y (code 1)     | Baugruppe (Welle mit Paßfeder) (Typ 1) | Arbre et clavette ass. (code 1)  | 074-00616                     | 1                    |
| ●              | Shaft and bearing ass'y (code 3) | Baugruppe (Welle u. Lager) (Typ 3)     | Arbre et roulement ass. (code 3) | S14-13634                     | 1                    |

### Model Code - Typenschlüssel - Désignation-type

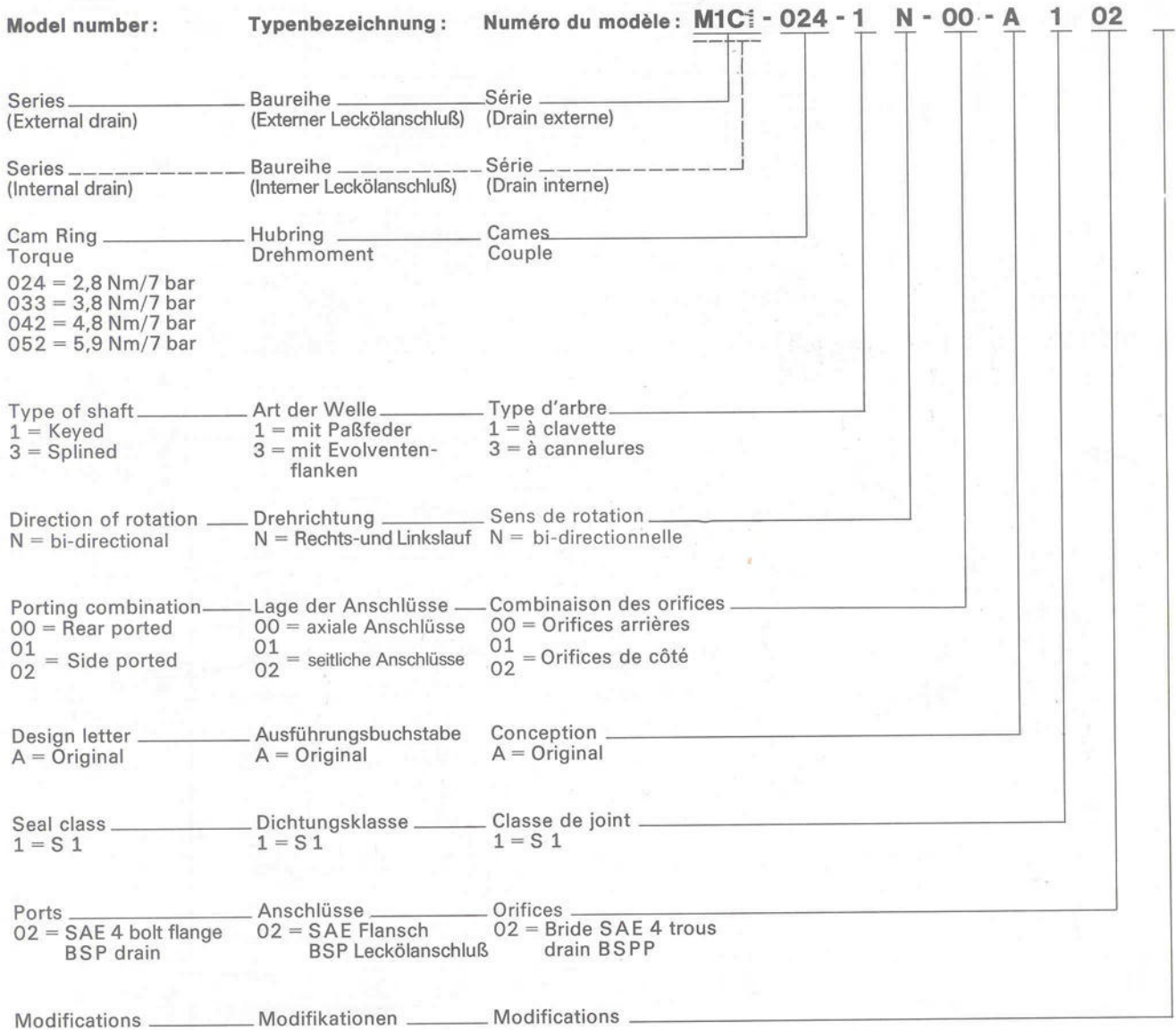

|          |                |
|----------|----------------|
| Print    | 02 / 93 / 2000 |
| Replace  | S5 - T151 - E  |
| Revision |                |

emp. originale vierzon  
Printed in France