

ToughCoils

Model Code S,P,J and H Series Coils

MCSCJ012DG000010

Model Code

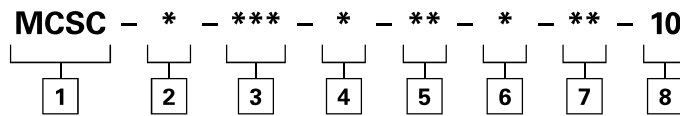

1 Function

MCSC - Solenoid coil

2 Series

S - Size 8 (210 Bar)
P - Size 8 (350 Bar)
J - Size 10, 12, 16, 20 (210 Bar)
H - Size 10, 12, 16, 20 (350 Bar)

3 Voltage Rating

012 - 12 volt
024 - 24 volt
036 - 36 volt
048 - 48 volt
115 - 115 volt
230 - 230 volt

4 Voltage Type

D - DC
B - DC/with flyback diode
A - AC/with full bridge rectifier

5 Connector

G0 - ISO 4400 DIN 43650
Q0 - Spade Terminals
W0 - Flying lead
N0 - Deutsch Male, DT04-2P, Integrated (DC Only)
 Mating Connector: Deutsch DT06-2S
Y0 - Amp Jr (DC Only)
 Mating Connector: AMP 963040-3 or equivalent
D0 - MetriPack® 150 Male, Integrated (DC Only)
 Mating Connector: Delphi 12052641

J0 - MetriPack® 280 Male, Integrated (DC Only)
 Mating Connector: Delphi 15300027
E0 - Weather-Pack (Packard) female on wire leads
 Mating Connector: Delphi 12010973
F0 - Weather-Pack (Packard) male on wire leads
 Mating Connector: Delphi 12015792

Note: Auxillary parts for mating connectors may be required.

6 Lead Length

0 - None
A - 152mm [6.0 in] (Standard length with connector)
B - 610mm [24.0 in] (Standard length without connector)

7 Special Features

00 - None
 (Only required if valve has special features, omitted if "00.")

8 Design Code

10 - Design code

Specifications

Ratings and Specifications

Duty Rating	Continuous from 85% to 110% of nominal voltage
Operating temperature	100°C (212°F) continuous @ nominal voltage
Lead Wires	18 gauge, standard 610 mm (24") long, UL style 3173 CSA CL 1251 (meets SAE J1128 XLPE style SXL)
Power Rating	S Series: 20W P Series: 23W J Series: 23W H Series: 29W
Encapsulant	Glass filled nylon
Magnet Wire	U.L. class N, 200°C (392°F) NEMA pub. No. MW 1000, section MW 35 - C (single)
Flyback diode (arc suppressor)	Maximum recurrent peak reverse voltage - 800 V (optional)

Environmental Protection

Connector	Ip65	Ip67	Ip69k	Thermal Shock Dunk
G0: DIN 43650	X*			
Q0: Spade				
Y0: Amp Jr.	X	X ¹ *		
W0: Wire Leads	X	X		X ¹
N0: Deutsch	X	X	X	X
D0: Metri-Pack 150	X	X	X	X
J0: Metri-Pack 280	X	X	X	X



CAUTION

Coils may be hot to touch if used in continuous duty applications.

¹Passed environmental testing, but not as robust as other connectors
 *Rating dependent on mating connector

Where measurements are critical request certified drawings. We reserve the right to change specifications without notice.

C-4.A

EATON Screw-In Cartridge Valves E-VLSC-MC001-E December 2009



ToughCoils

For 10, 12, 16 and 20 Size Solenoid Valves

J & H Series Coils

300AA00____ (Complete Part number is 11 Digits)

Voltage	G0** Connector	Q0 Connector	W0 Connector	NO Connector	YO Connector	D0 Connector	JO Connector
12VDC	081A	089A	095A	101A	106A	111A	116A
24VDC	082A	090A	096A	102A	107A	112A	117A
36VDC	083A	091A	097A	103A	108A	113A	118A
24VAC	084A	092A	098A	-	-	-	-
115VAC	085A	-	-	-	-	-	-
230VAC	086A	-	-	-	-	-	-
12VDC*	087A	093A	099A	104A	109A	114A	119A
24VDC*	088A	094A	100A	105A	110A	115A	120A

*With flyback diode. (Voltage Type B)

**DIN 43560 mating connector for "G0" style coil – 02-166796.

For other voltages and connectors contact your Eaton representative.

Std. Voltages	Amperes*
12 DC	1.92
24 DC	0.96
36 DC	0.64
24 AC	1.06
115 AC	0.22
230 AC	0.11

Nominal voltage 25°C (77°F).

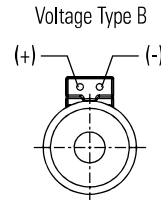

H Series ToughCoils part numbers - 300AA00____ (Complete Part number is 11 Digits)

Voltage	G0** Connector	Q0 Connector	W0 Connector	NO Connector	YO Connector	D0 Connector	JO Connector
12VDC	121A	129A	135A	141A	146A	151A	156A
24VDC	122A	130A	136A	142A	147A	152A	157A
36VDC	123A	131A	137A	143A	148A	153A	158A
24VAC	124A	132A	138A	-	-	-	-
115VAC	125A	-	-	-	-	-	-
230VAC	126A	-	-	-	-	-	-
12VDC*	127A	133A	139A	144A	149A	154A	159A
24VDC*	128A	134A	140A	145A	150A	155A	160A

*With flyback diode. (Voltage Type B)

**DIN 43560 mating connector for "G0" style coil – 02-166796.

For other voltages and connectors contact your Eaton representative.

Std. Voltages	Amperes*
12 DC	2.42
24 DC	1.21
36 DC	0.81
24 AC	1.34
115 AC	0.28
230 AC	0.14

*Nominal voltage 25°C (77°F).

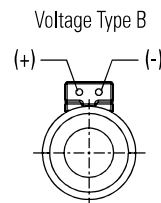

Where measurements are critical request certified drawings. We reserve the right to change specifications without notice.

J Series Coils

Dimensions

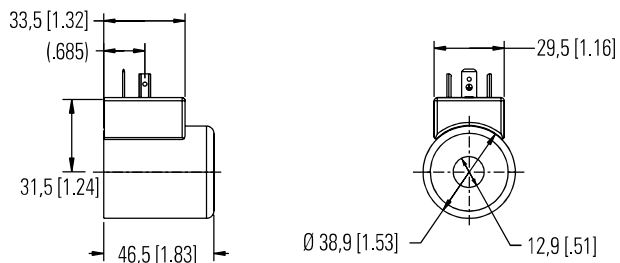

G0
DIN 43650-A Connector



Shown with integrated MetriPack 150 Connector

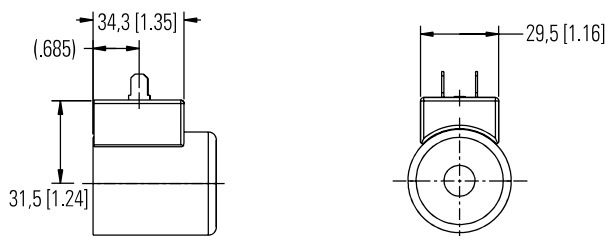

Q0
Spade Connector

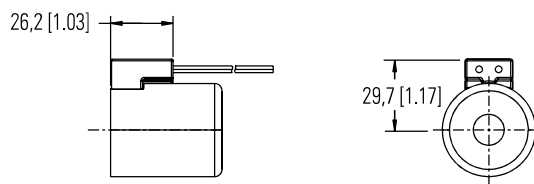

W0
Leadwire

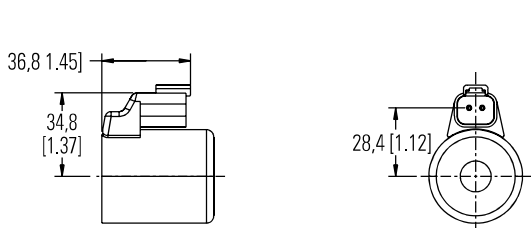

N0
Deutsch Male DTO4-2P integrated connector

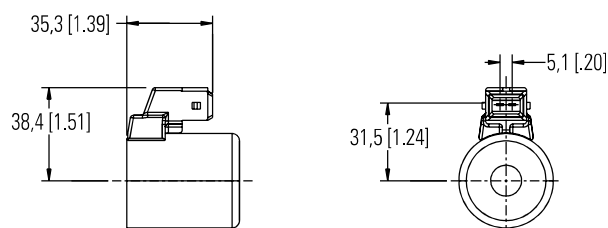

Y0
AMP Junior Timer integrated connector

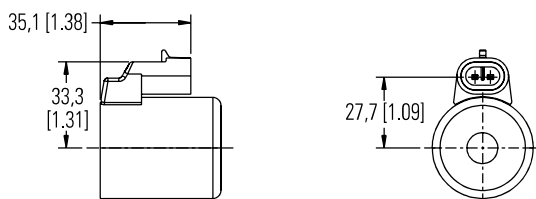

D0
Metri-Pack 150 Male, integrated connector

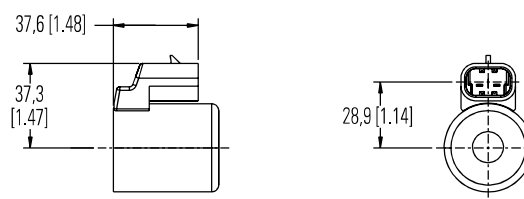

J0
Metri-Pack 280 Male, integrated connector

Where measurements are critical request certified drawings. We reserve the right to change specifications without notice.