

Diese Zeichnung darf weder ganz noch teilweise ohne unsere ausdrückliche Genehmigung kopiert oder auf andere Weise vervielfältigt werden. Alle Rechte vorbehalten.

Alla rättigheter förbehålls. All rights reserved. Alle Rechte vorbehalten.

Denna handling får ej utan vårt medgivande delges annan, kopieras eller eljest obehörigen användas. Överlåtelse härvid beivras med stöd av gällande lag. This document must not be copied, either completely or in part, without permission. Any infringement will have legal consequences.

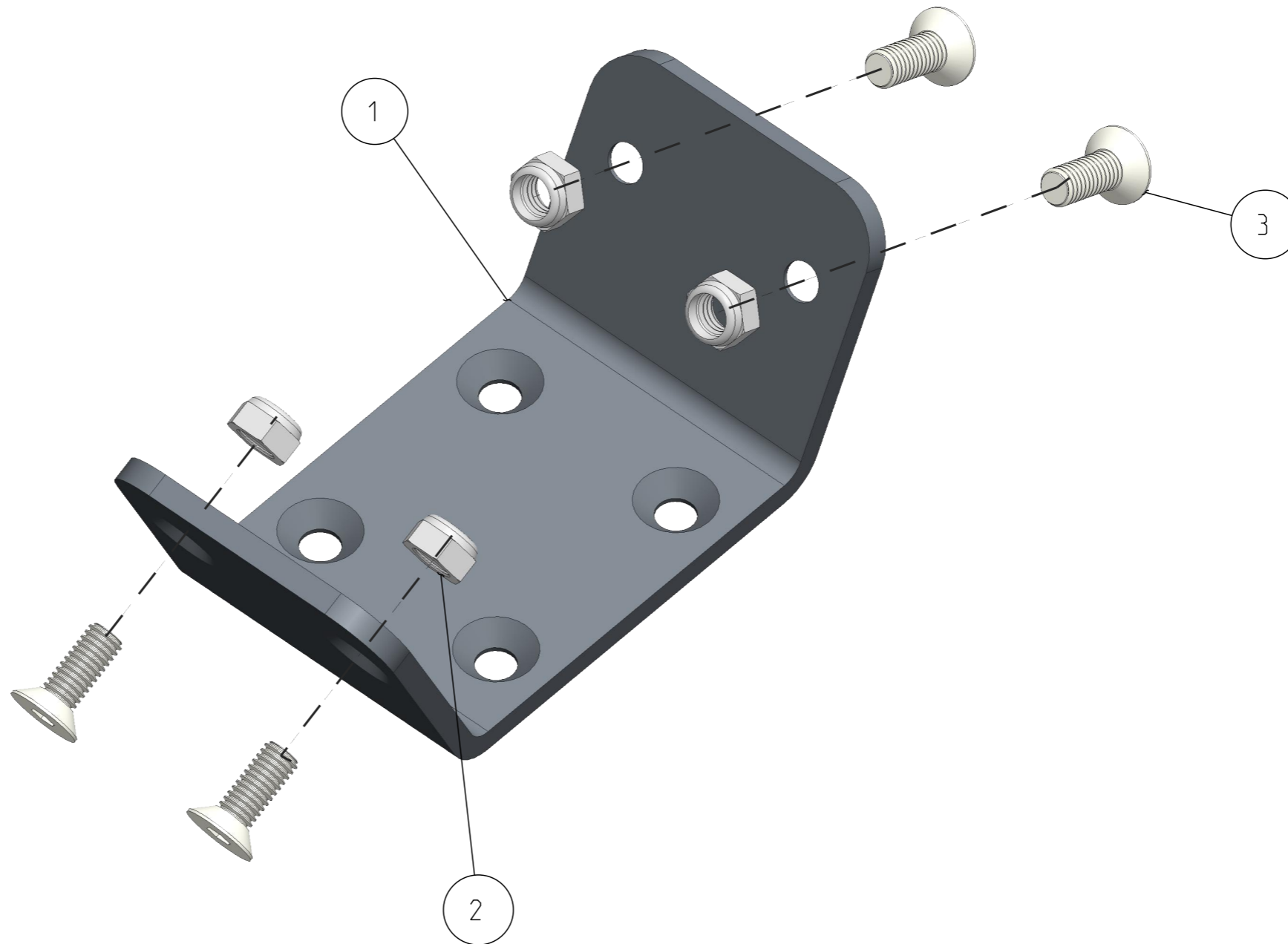
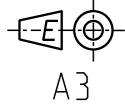

Product no.: 10_932_4965	
Max working pressure:	bar connected bar disconnected
Min burst pressure:	bar connected bar disconnected
Sealing material:	
Temperatur range:	°C - °C
Nominal flow diameter, DN:	mm
Connection	
Connection stroke:	mm

3	4	Screw	Steel / FZB	09_932_0902
2	4	Lock nut M6	Steel / FZB	09_932_0801
1	1	Fixation plate	Steel	09_932_6502
Detalj Item	Antal Quant.	Benämning Description	Material Material	Detaljnummer Detail number

CEJN	Skala Scale	N/A	Ritad Drawn	CEJN ABPEOD	Kontr. Checked	JoEr	Godk. Appr.	PMB	Äm nr. Alt. no.	-	Dat. Date	13-01-28
	Assembly drawing							Ritning nr./Drawing No.		50_932_4965		Utg./Issue